

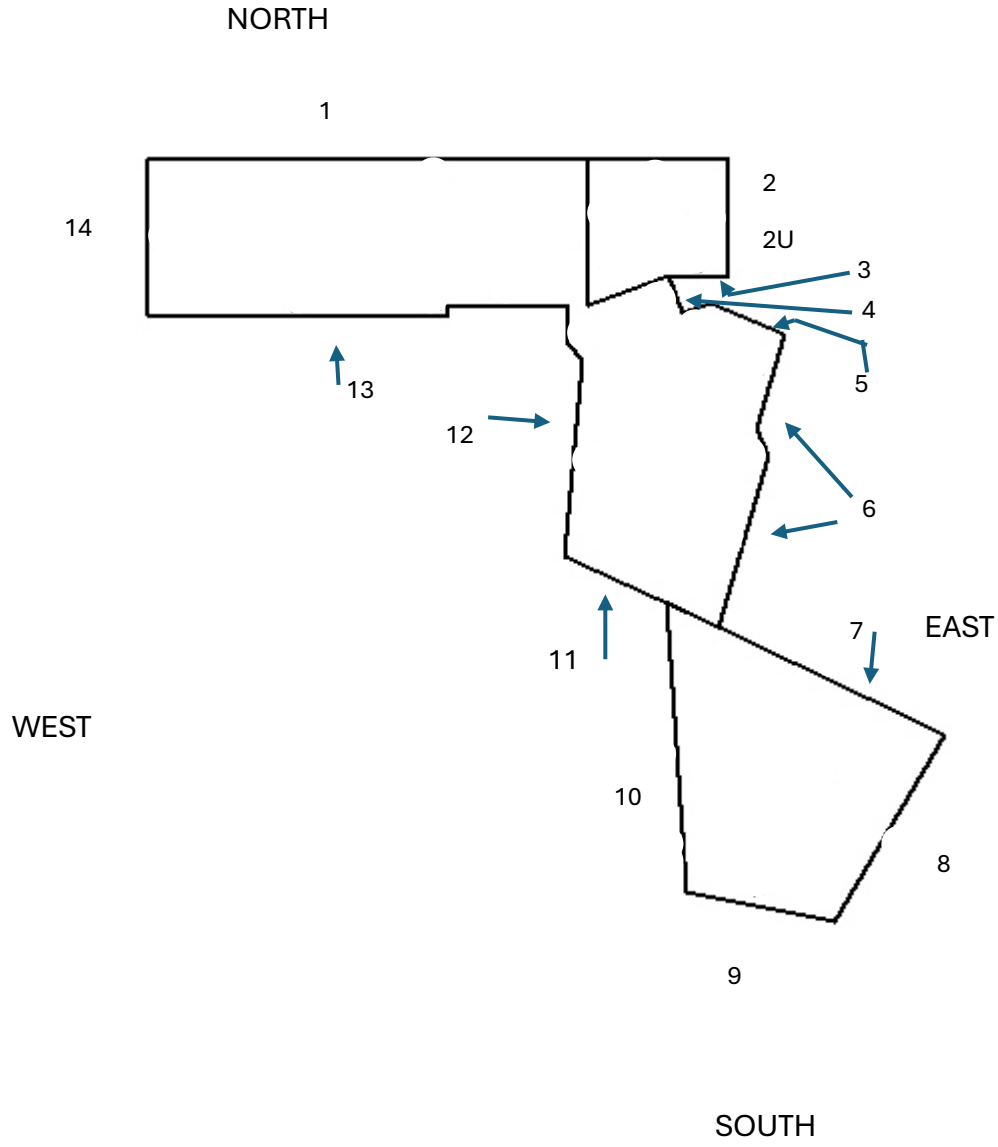

# Façade Diagram



# Historic Cultural Properties Inventory (HCPI) Base Form (FORM 1)

*Historic Preservation Division, New Mexico Department of Cultural Affairs*

For HPD Office use only: HCPI No. _____ District No. _____ NRHP <input type="checkbox"/> SRCP <input type="checkbox"/> Criteria <u>  </u> A <u>  </u> B <u>  </u> C <u>  </u> D		
<b>1. Name of property:</b> None	<b>2. Location:</b> 640 Camino de la Luz Santa Fe, NM 87505	<b>3. Local Reference Number:</b>  <b>4. County</b>  Santa Fe County, NM
<b>5. Property Type:</b> <input checked="" type="checkbox"/> Building <input type="checkbox"/> Structure <input type="checkbox"/> Site <input type="checkbox"/> Object		
<b>6. Date of Survey:</b> 9/15/2005		
<b>7. Previous Survey Date(s):</b> ___/___/___ <input checked="" type="checkbox"/> No previous survey		
<b>8. Name of Project:</b>  		
<b>9. UTM (NAD83)</b> Zone: 13 Easting: 1368540 Northing: 12953550		
<b>10. Photo Information</b> <b>Disk Location:</b> <b>View of: Front Facade (east)</b>  Digital Photography held by City of Santa Fe, 202 Lincoln Ave, Santa Fe, NM 87501		
<b>11. Brief Description of the Property:</b> Freestanding single-family house in the Spanish-Pueblo Revival style.		
<b>12. Who uses the property?</b> Private residence.		
<b>13. Construction Date:</b>  Date: 1960-1969                      ___ Known <input checked="" type="checkbox"/> Estimated      Source: David Padwa		
<b>14. Setting:</b>  ___ Suburban ___ Rural ___ Village <input checked="" type="checkbox"/> Urban      If Urban: ___ Commercial ___ Industrial <input checked="" type="checkbox"/> Residential ___ Public		
<b>15. Relationship to Surroundings:</b> <input checked="" type="checkbox"/> Similar    ___ Dissimilar  <b>Comments:</b>		

**HCPI Base Form (FORM 1)**

*(Continued from other side)*

**16. Additional Perspective: East Facade**



**17. Surveyor:**  
(your name, address, telephone number, and any group affiliation)

Roy Wroth, Urbanist  
P.O. Box 1514  
Santa Fe, NM 87504

**18. Owner (if known) and other knowledgeable people:**

David Padwa

**19. Is Property Endangered?**     Unknown  No  Yes    How?

**20. Significance to Current Community:**     Unknown  None  Low  Moderate  High

Describe:

**21. Other Significance or Information of Interest:** (such as historical, legendary, structural, former ownership, etc.)

**22. National or State Register:**

Is this property individually listed on a historic register?  Unknown  No  Yes  
If yes:  State  National

If 'no' or unknown, do you think this property is eligible for listing?  No  Yes

Why? Property has no known association with historic persons or events, consists of multiple additions, and is less than 50 years old.

**23. National or State Historic District:**

Is this property in a historic district?  Unknown  No  Yes  
If yes:  Contributing  Non-contributing  Unknown

If 'yes', what is the name of the district? \_\_\_\_\_  State  National

**24. Supplemental Forms:**

None  HCPI Detail Form (FORM 2)  Continuation Sheets, # pages: \_\_\_\_\_

# Historic Cultural Properties Inventory (HCPI) Detail Form (FORM 2)

*Historic Preservation Division, New Mexico Department of Cultural Affairs*

For HPD Office use only:		Please complete HCPI FORM 1 before completing FORM 2																	
HCPI No. _____	District No. _____	NRHP _____	SRCP _____																
Criteria <u>  </u> A <u>  </u> B <u>  </u> C <u>  </u> D																			
<b>1. Name of property:</b>  None	<b>2. Location:</b>  640 Camino de la Luz Santa Fe, NM 87505	<b>3. Local Reference Number:</b>  <table border="1" style="width: 100%; border-collapse: collapse;"> <tr> <td style="padding: 2px;"><b>4. County</b></td> </tr> <tr> <td style="padding: 2px;">Santa Fe County, NM</td> </tr> <tr> <td style="padding: 2px;"><b>5. Date of Survey:</b> 9/15/2005</td> </tr> </table>	<b>4. County</b>	Santa Fe County, NM	<b>5. Date of Survey:</b> 9/15/2005														
<b>4. County</b>																			
Santa Fe County, NM																			
<b>5. Date of Survey:</b> 9/15/2005																			
ARCHITECTURAL AND CONSTRUCTION DETAILS:																			
<b>6. Visible Construction Material:</b>  <input type="checkbox"/> Adobe <input type="checkbox"/> Brick <input type="checkbox"/> Composition <input type="checkbox"/> Concrete: Block  <input type="checkbox"/> Concrete: Cast Stone <input type="checkbox"/> Concrete: Poured <input type="checkbox"/> Earth Plaster <input type="checkbox"/> Masonry: Simulated  <input type="checkbox"/> Metal: Corrugated <input type="checkbox"/> Metal: Structural Siding <input type="checkbox"/> Metal: V-Crimp <input type="checkbox"/> Stone: Random Ashlar  <input type="checkbox"/> Stone: Random Coursed <input type="checkbox"/> Stone: River Rock <input checked="" type="checkbox"/> Stone: Rusticated <input type="checkbox"/> Stone: Tabular  <input checked="" type="checkbox"/> Stucco <input type="checkbox"/> Tile: Clay <input type="checkbox"/> Vinyl Siding <input type="checkbox"/> Wood: Board and Batten  <input type="checkbox"/> Wood: Horizontal Siding <input checked="" type="checkbox"/> Wood: Jacal <input type="checkbox"/> Wood: Log <input type="checkbox"/> Wood: Shingle  <input type="checkbox"/> Wood: Tongue and Groove <input type="checkbox"/> Other: _____		<b>7. Number of Stories:</b> <u>  </u> N/A Number: <u>  </u> 1 <input checked="" type="checkbox"/> 1 1/2 <u>  </u> 2 <u>  </u> 2 1/2 Other: _____  <b>8. Foundation:</b> <u>  </u> N/A <input type="checkbox"/> Not visible <input type="checkbox"/> None <input type="checkbox"/> At Grade <input checked="" type="checkbox"/> Raised Materials: <u>  </u> Concrete <input checked="" type="checkbox"/> Stone Other: _____ Notes: _____  <b>9. Roof:</b> <u>  </u> N/A Shape: <input checked="" type="checkbox"/> Flat <input type="checkbox"/> Gabled <input type="checkbox"/> Hipped <input type="checkbox"/> Pyramidal <input type="checkbox"/> Shed Other: _____ Pitch: <input type="checkbox"/> None <input type="checkbox"/> Low <input type="checkbox"/> Medium <input type="checkbox"/> Steep Features: <input type="checkbox"/> Eave <input checked="" type="checkbox"/> Parapet Materials: <input type="checkbox"/> Asphalt <input type="checkbox"/> Earth <input type="checkbox"/> Composition shingle <input type="checkbox"/> Metal: Pressed <input type="checkbox"/> Composition Roll <input type="checkbox"/> Metal: Corrugated <input type="checkbox"/> Metal: Standing Seam <input type="checkbox"/> Metal: V- Crimp <input type="checkbox"/> Tile: Terra Cotta <input type="checkbox"/> Wood: Shingle Other: _____																	
<b>10. Windows</b> <u>  </u> N/A  <table border="1" style="width: 100%; border-collapse: collapse;"> <thead> <tr> <th style="width: 15%;">Operation</th> <th style="width: 15%;">Material</th> <th style="width: 15%;">Glazing</th> <th style="width: 15%;">Number</th> </tr> </thead> <tbody> <tr> <td colspan="4">Metal clad double hung, plate glass and casements, no muntins; large fixed bays with true divided lite, metal clad; 2 bay 6-lite casements, metal clad.</td> </tr> </tbody> </table> Notes: _____		Operation	Material	Glazing	Number	Metal clad double hung, plate glass and casements, no muntins; large fixed bays with true divided lite, metal clad; 2 bay 6-lite casements, metal clad.				<b>11. Doors</b> <u>  </u> N/A  <table border="1" style="width: 100%; border-collapse: collapse;"> <thead> <tr> <th style="width: 15%;">Type</th> <th style="width: 15%;">Style</th> <th style="width: 15%;">Material</th> <th style="width: 15%;">Number</th> </tr> </thead> <tbody> <tr> <td colspan="4">Antique paneled door, two leaf, forged hardware; wood panel door, no lites.</td> </tr> </tbody> </table> Notes: _____		Type	Style	Material	Number	Antique paneled door, two leaf, forged hardware; wood panel door, no lites.			
Operation	Material	Glazing	Number																
Metal clad double hung, plate glass and casements, no muntins; large fixed bays with true divided lite, metal clad; 2 bay 6-lite casements, metal clad.																			
Type	Style	Material	Number																
Antique paneled door, two leaf, forged hardware; wood panel door, no lites.																			
<b>12. Chimneys</b> (describe whether interior or exterior and material) Integrated in stuccoed masonry walls, exposed stone masonry above roofline, some metal caps.		<b>13. Porches</b> <u>  </u> N/A  Rear porch: outdoor sitting room with fireplace and square timber columns and beams, protruding viga ends																	
<b>14. Other Significant Features</b> Rustic wood railing and eyebrow shade structure on roof terrace; exposed stone foundations, chimney caps, and parapet caps; rustic stone masonry around entry door.																			
<b>15. Modifications:</b> <u>  </u> No known modifications  #1 Upper portion of house added Date: 1970-79 Known <input checked="" type="checkbox"/> Estimated    Source: David Padwa  #2 _____ Date: _____ Known <input type="checkbox"/> Estimated <input type="checkbox"/> Source: _____																			

# HCPI Detail Form (FORM 2)

(Continued from other side)

## 16. Primary Architectural Style Not Applicable

- |  |   |  |   |  |
|--|---|--|---|--|
| <input type="checkbox"/> Art Deco/Streamline Moderne | <input type="checkbox"/> Gothic Revival | <input type="checkbox"/> Mission Revival | <input type="checkbox"/> Pueblo           | <input checked="" type="checkbox"/> Spanish-Pueblo Revival |
| <input type="checkbox"/> Bungalow/Craftsman          | <input type="checkbox"/> International  | <input type="checkbox"/> Neo-Classical   | <input type="checkbox"/> Queen Anne       | <input type="checkbox"/> Territorial                       |
| <input type="checkbox"/> Colonial Revival            | <input type="checkbox"/> Italianate     | <input type="checkbox"/> Northern NM     | <input type="checkbox"/> Ranch            | <input type="checkbox"/> Territorial Revival               |
| <input type="checkbox"/> Folk Victorian              | <input type="checkbox"/> Mediterranean  | <input type="checkbox"/> Prairie         | <input type="checkbox"/> Spanish-Colonial | <input type="checkbox"/> Tudor Revival                     |

Notes: \_\_\_\_\_ Other: \_\_\_\_\_

## 17. Documents Available and Their Locations

SITE :

## 18. Attached or Associated Properties

Are associated properties eligible for listing?

## 19. Site Plan:



**THE ATTACHED SURVEY FORM REFLECTS  
HISTORIC BUILDING SURVEY WORK THAT WAS  
COMPLETED IN SEPTEMBER 2005.**

**RESULTS OF THE SURVEY AS REFLECTED ON  
THE ATTACHED HAVE NOT BEEN ADOPTED BY  
THE HISTORIC DESIGN REVIEW BOARD. IT  
SHOULD BE CONSIDERED PRELIMINARY FOR  
PURPOSES OF PLANNING.**

**PLEASE SEE DAVID OR MARISSA FOR  
MORE INFORMATION OR CLARIFICATION.**

ADM# 172



City of Santa Fe, New Mexico

**HISTORIC PRESERVATION SECTION  
OF THE PLANNING DIVISION**

**To:** Building Permit Office

**From:** David A. Rasch, Section Head DR  
Marissa C. Barrett, Case Planner  
Gary S. Moquino, Inspector

**Date:** 8.8.06

The work proposed at 640 Camino de la Luz does not need to go to the Historic Design Review Board for review. Please allow the applicant to submit for building permit review. The permit shall be routed for review by Historic Design Review Board staff in the Planning Division.

**Proposed Work:**

restucco - El Rey cementitious  
to match existing color

**Thank You.**



**City of Santa Fe**  
Land Use Department | Historic Preservation Division

**Administrative Approval**

***THIS IS NOT A CONSTRUCTION PERMIT***

***DO NOT BEGIN WORK WITHOUT A PERMIT. SUBMIT THIS FORM WITH YOUR CONSTRUCTION PERMIT APPLICATION AND RETAIN A COPY AT THE JOB***

**Date:** November 12, 2025

**To:** Building Permit Division

**From:**

A handwritten signature in black ink that reads "Jane Rodriguez".

Jane Rodriguez

*Be advised that per §14-5.2 SFCC 1987 the work described below at the referenced address does NOT require Historic Districts Review Board approval and is hereby staff-approved as described below. Please allow the applicant to submit for a construction permit(s) for this work if required.*

**Project Address:** 640 CAMINO DE LA LUZ, Santa Fe, NM 87505

**Case Number:** 2025-011523--ADMIN

**Contact Name:** REESE CUSTOM BUILDERS

**Phone Number:** 505-699-2150

**Email:** jreese.rcb@gmail.com

**Approved Scope of Work:** *Re-roof 630 sq. ft. of structure using TPO and a rigid insulation as submitted.*

**Conditions of Approval:** *There shall be no publicly visible rooftop appurtenances and no roofing material shall be on the top of the parapets and shall be flashed on interior of parapets.*

*There shall be no changes to existing skylights, canals, solar, mechanical, line sets, or other rooftop appurtenances at this time.*

*No other work approved at this time.*

**FURTHER ACTIONS REQUIRED: PERMIT or PERMIT REVISION  
FINAL HISTORIC INSPECTION**