

ST. FRANCIS DRIVE

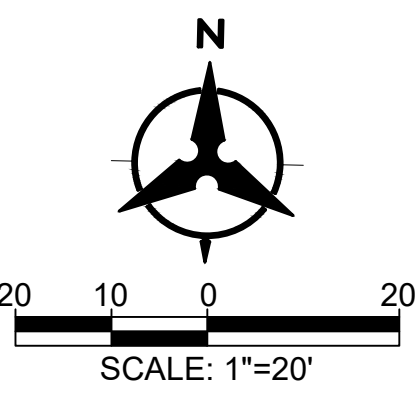

NOTE: SEE SHEETS S101 & S102 FOR ST. FRANCIS AND ZIA TRAFFIC SIGNAL MODIFICATIONS AND DETAILS.

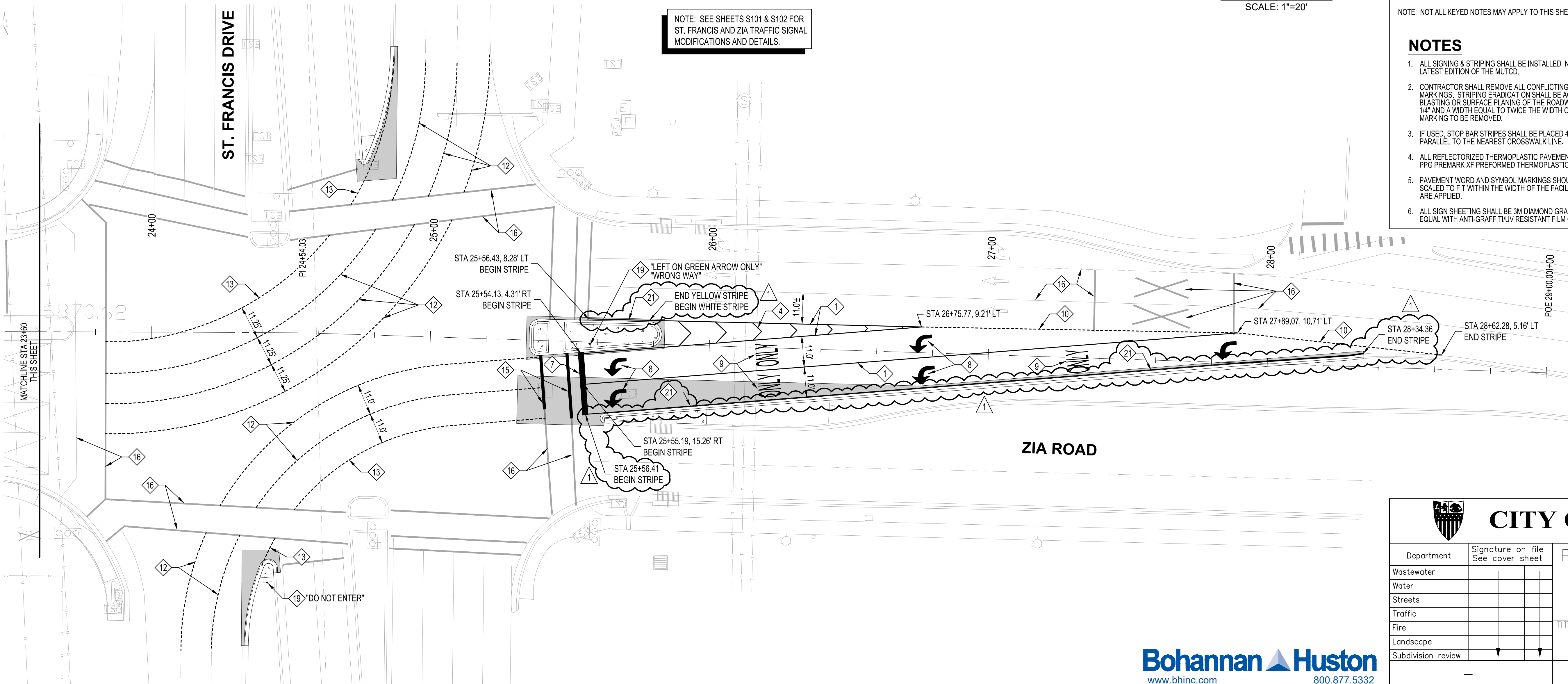

SIGNING & STRIPING KEYED NOTES

1. INSTALL EXTRUDED THERMOPLASTIC PAVEMENT MARKING - 4" SOLID WHITE STRIPE
2. INSTALL EXTRUDED THERMOPLASTIC PAVEMENT MARKING - 4" DASHED WHITE STRIPE. SEE DETAIL ON SHEET R114.
3. INSTALL EXTRUDED THERMOPLASTIC PAVEMENT MARKING - 4" DOUBLE SOLID YELLOW STRIPE
4. INSTALL 4" SOLID WHITE EXTRUDED THERMOPLASTIC PAVEMENT MARKING CHEVRONS (20' APART)
5. INSTALL EXTRUDED THERMOPLASTIC PAVEMENT MARKING - 6" DOTTED WHITE STRIPE (3' STRIPE w/ 9' GAP)
6. INSTALL EXTRUDED THERMOPLASTIC PAVEMENT MARKING - 6" SOLID WHITE STRIPE
7. INSTALL REFLECTORIZED THERMOPLASTIC PAVEMENT MARKING - 24" SOLID WHITE STOP BAR
8. INSTALL RETROREFLECTIVE PREFORMED PATTERNED OR THERMOPLASTIC PAVEMENT MARKING: LEFT ARROW, RIGHT ARROW OR THRU/RIGHT ARROW. SEE DETAIL ON SHEET R114.
9. INSTALL RETROREFLECTIVE PREFORMED PATTERNED PAVEMENT MARKING: WORD ONLY. SEE DETAIL ON SHEET R114.
10. INSTALL EXTRUDED THERMOPLASTIC PAVEMENT MARKING - 4" DOTTED WHITE STRIPE (3' STRIPE w/ 9' GAP)
11. INSTALL REFLECTORIZED THERMOPLASTIC PAVEMENT MARKING - RAILROAD CROSSING SYMBOL.
12. INSTALL EXTRUDED THERMOPLASTIC PAVEMENT MARKING - 4" DOTTED WHITE STRIPE (2' LINE, 4' SPACE). ERADICATE CONFLICTING PAVEMENT MARKINGS.
13. INSTALL EXTRUDED THERMOPLASTIC PAVEMENT MARKING - 4" DOTTED YELLOW STRIPE (2' LINE, 4' SPACE). ERADICATE CONFLICTING PAVEMENT MARKINGS.
14. INSTALL POST MOUNTED SIGN.
15. INSTALL REFLECTORIZED THERMOPLASTIC PAVEMENT MARKING - CROSSWALK. 24" WIDE THERMOPLASTIC PAVEMENT MARKING SPACED @ 5.25' O.C. (3.25' GAP). MARKING SHALL BE OUTSIDE OF WHEEL PATH.
16. EXISTING STRIPING TO REMAIN.
17. PAINT MEDIAN NOSE YELLOW FOR 10 LF.
18. INSTALL REFLECTORIZED THERMOPLASTIC PAVEMENT MARKING - CROSSWALK. 18" WIDE THERMOPLASTIC PAVEMENT MARKING SPACED @ 4.25' O.C. (2.75' GAP). MARKING SHALL BE OUTSIDE OF WHEEL PATH.
19. REINSTALL EXISTING POST MOUNTED STREET SIGN.
20. INSTALL SIGN.
21. INSTALL EXTRUDED THERMOPLASTIC PAVEMENT MARKING - 4" SOLID YELLOW STRIPE

NOTE: NOT ALL KEYED NOTES MAY APPLY TO THIS SHEET.

NOTES

1. ALL SIGNING & STRIPING SHALL BE INSTALLED IN ACCORDANCE WITH THE LATEST EDITION OF THE MUTCD.
2. CONTRACTOR SHALL REMOVE ALL CONFLICTING EXISTING PAVEMENT MARKINGS. STRIPING ERADICATION SHALL BE ACCOMPLISHED BY WATER BLASTING OR SURFACE PLANING OF THE ROADWAY, TO A MAX. DEPTH OF 1/4" AND A WIDTH EQUAL TO TWICE THE WIDTH OF THE STRIPE OR MARKING TO BE REMOVED.
3. IF USED, STOP BAR STRIPES SHALL BE PLACED 4' IN ADVANCE OF AND PARALLEL TO THE NEAREST CROSSWALK LINE.
4. ALL REFLECTORIZED THERMOPLASTIC PAVEMENT MARKINGS SHALL BE PPG PREMARK XF PREFORMED THERMOPLASTIC.
5. PAVEMENT WORD AND SYMBOL MARKINGS SHOULD BE PROPORTIONALLY SCALED TO FIT WITHIN THE WIDTH OF THE FACILITY UPON WHICH THEY ARE APPLIED.
6. ALL SIGN SHEETING SHALL BE 3M DIAMOND GRADE 36 OR APPROVED EQUAL WITH ANTI-GRAFFITI/UV RESISTANT FILM OVERLAY.

SURVEY INFORMATION		FIELD NOTES	
NO.	BY	NO.	DATE

ENGINEER'S SEAL

Glenn S. Broughton
14171
REGISTERED PROFESSIONAL ENGINEER
New Mexico

NO.	DATE	BY	REVISIONS
1	5/23/25	BO/CSB	ADDED MEDIAN STRIPING

Designed By: GSB	DATE: 3/2024
Drawn By: BO	DATE: 3/2024
Checked By: GSB	DATE: 3/2024

CITY OF SANTA FE

Department: Wastewater, Water, Streets, Traffic, Fire, Landscape, Subdivision review

Signature on file See cover sheet

PROJECT: ZIA STATION FINAL DEVELOPMENT PLAN

TITLE: ZIA ROAD SIGNING & STRIPING PLAN

Sheet R115