

City of Santa Fe, New Mexico

memo

DATE: March 10, 2026

TO: Historic Districts Review Board Members

VIA: Heather Lamboy, Planning & Land Use Department Director #LL
Maggie Moore, Assistant Land Use Director
Gary Moquino, Historic Preservation Division Manager

FROM: Amanda Romero, Senior Planner, Historic Preservation Division ALR

2026-011972-HDRB. 669 Garcia St., Downtown & Eastside Historic District. Non-contributing. Jeffrey Seres, agent for Christine Teneyck & Gary Deaver Owners, LLC, owners, proposes to construct 5' yard wall, pedestrian and vehicular gates, and demolish a portion of a stone retaining wall. An exception is requested to 14-4.6 (F)(2)(II)(c) for a 5'-0" yard wall, where 4'-2" is permitted.

REFERENCE ATTACHMENTS (Sequentially):

CITY SUBMITTALS

District Standards & yard wall
& fence standards.

Historic Inventory Form

Zoning Review Sheet

Other: Admin-2022-005861
Wall Height Calculation

APPLICANT SUBMITTALS

Proposal Letter

Site Plan/Floor Plan

Elevations

Photographs

Other: Exception Criteria

STAFF RECOMMENDATION:

Staff recommends approval of the proposed project and finds that the application does comply with Section 14-4.6(E) General Design Standards for all Historic Districts, and 14-4.6(G)(2) Downtown and Eastside Design Standards.

Staff finds that the exception criteria have been met and recommends approval of the exception requested to 14-4.6 (F)(2)(II)(c) for a 5'-0" yard wall, where 4'-2" is permitted.

Sample motions:

One motion will be required in this case.

- a. In case 2026-011972-HDRB, for 669 Garcia St., approve or deny the application as submitted.
- b. In case 2026-011972-HDRB, for 669, Garcia St., approve/deny the exception to 14-4.6 (F)(2)(II)(c) for a 5'-0" yard wall, where 4'-2" is permitted, finding that the exception criteria have been met

Should the Board deny the exception request, the applicant shall return with an alternative proposal for review and approval before proceeding to a building permit.

The property lies within the River and Trails Archaeological Review District. See Chapter 14, SFCC, Article 14-3.13(B)(1). There may be archaeological concerns associated with this project, and archaeological clearance may be required.

BACKGROUND & SUMMARY:

Streetscape:

The Garcia Street streetscape includes a mix of historic and non-historic structures. The farther south one proceeds from the Garcia Street and Acequia Madre intersection, the density is lower, the lots are larger, and the road takes on a more rural character.

Site Description:

The majority of the single-family residence is set back more than 30 feet from Garcia Street. The two-story residence is stepped with the terrain, which falls away from the Garcia Street elevation. The building's two-story mass is stepped back from the street, thereby having a small impact on the overall appearance of height from the street.

The proposed yard wall meanders along the western property line. Because the yard wall has been designed around an existing tree, its overall visual impact will be greatly reduced.

PREVIOUS CASE SUMMARIES:

ADMINISTRATIVE: 2022-005861—ADMIN Portal and door replacement

APPLICANT'S REQUEST:

The applicant proposes the following exterior alterations:

- 1) A wooden 4'9" pedestrian gate and a wooden 6'0" vehicular gate.
- 2) Proposed 5'0" yard wall ornamented with pilasters and stepped with the terrain.

EXCEPTION CRITERIA AND RESPONSES:

Exception to 14-4.6(F)(2)(II)(c): The applicant requests an exception to permit a 5'0" yard wall where 4'2" is permitted.

(i) Do not damage the character of the district

Applicant Response: The proposed yard wall and vehicle and pass gates at 669 Garcia St. will be in proportion to its setting and surroundings. They will fit within the context of the existing streetscape along Garcia St. with the great majority of existing residences having yard walls and pass gates and some with vehicle gates. Many of these existing walls are at the back of existing sidewalks only 4' or 5' off the street line, greater than 6' in height, and visually prominent.

The proposed yard wall and gates will be at a minimum 15' -6" off the street line keeping in character of the residences at the upper (south) end of Garcia St. The yard wall will also curve to avoid the removal of existing pinon and elm trees along the street keeping visibility to the yard wall and gates less prominent from the street. The yard wall will meet with existing 5' -0" high walls on the both sides of the property. The proposed yard wall and gates with a maximum height of 6'-0" for the vehicle gate and 5' -0" for the yard wall are in proportion to its setting and will enhance, rather than damage the character of the streetscape.

Staff Response: Staff finds that this criterion is met. The applicant has designed the yard wall to preserve some of the landscaping along Garcia Street, which helps in reducing the overall appearance of height.

(ii) Are required to prevent a hardship to the applicant or an injury to the public welfare

Applicant Response: The existing driveway entrance to 669 Garcia St. is directly across from the service and delivery entrance driveway to the School for Advanced Research (SAR) on the west side of Garcia St., a unique condition along the street. Medium and large size service and delivery vehicles use this entrance and exit from SAR on a daily basis. This entrance is to be widened to create the exclusive entrance for service vehicles to SAR. This pending change is known as Ms. TenEyck (owner of 669) is the landscape architect that has been selected to prepare a new Master Landscape Plan for SAR.

The proposed vehicle gate and the existing driveway entrance at 669 Garcia St. cannot be relocated due to the location of the existing garage and the car movement required out of the garage into the drive court to drive straight out onto Garcia St. and not have to back out. This will maintain direct visibility of the SAR service entrance to the front entrance of the residence. The proposed increase from the HPD staff calculated 4' -2" wall height to 5' -0" for the yard wall and 6' -0" for the vehicle gate will prevent a hardship by reducing the visual, sound, and pollution impact of medium and large size service vehicles entering and exiting from SAR. This service vehicle location for an institutional / commercial use (SAR) is completely unique to the residence at 669 Garcia St. The increased height (10") requested for the yard wall will also allow it to match the height of the existing walls at both sides of the property.

Staff Response: Staff finds that this criterion is met. The wall meanders away from the Garcia streetscape, which lowers the visual impact and provides for a more compatible character along the street. There is no injury to the public welfare with the proposed design and placement of the wall.

(iii) *Strengthen the unique heterogeneous character of the City by providing a full range of design options to ensure that residents can continue to reside within the historic districts*

Applicant Response: The proposed design option for the location of the yard wall and vehicle gate maintains existing car movement to exit straight out from the residence onto Garcia St. and maintains the existing mature trees and landscape along the street. The proposed yard wall and gates will not prevent residents to continue to reside at 669 Garcia St. within the Historic District.

Staff Response: Staff finds that this criterion is met. The applicant carefully designed the wall in a manner that will be compatible with the streetscape and will have the least impact possible.

(iv) *Are due to special conditions and circumstances which are peculiar to the land or structure involved and which are not applicable to other lands or structures in the related streetscape;*

Applicant's Response: Neither the size of the Subject Property at 669 Garcia effectively being reduced by half for the building area, the existing service entrance to SAR, or the existing landscape trees and plantings along the street, are the result of actions by the applicant. These conditions were created before ownership of the property by the current owners.

Staff Response: Staff finds that this criterion is met. Garcia Street traffic has increased over time. Due to the sensitive design of the yard wall, the difference of 8 inches will not make a great impact on the streetscape.

(v) *Are due to special conditions and circumstances which are not a result of the actions of the applicant; and*

Applicant's Response: The subject property at 669 Garcia St comprises a 25,443 SF (.58 AC) parcel that accommodates a single family residence and 2 car garage. The location of the residence and garage are close to west (street front side) of the property minimally set back from the street due to an existing arroyo within the back half of the property that reduced the effective lot building area by half. As noted above, the location of the SAR service entrance directly across from the driveway entrance to 669 Garcia St. is completely unique and is not applicable to any other land or structures in the related streetscape.

Staff Response: Staff finds that this criterion is met.

(vi) *Provide the least negative impact with respect to the purpose of this section as set forth in Subsection 14-5.2(A)(1).*

Applicant Response: Applicant's Response: As discussed above, the proposed yard wall and gates are in harmony and fit within the context of existing residential buildings adjacent and in the immediate vicinity. The height limit for walls calculated by HPD for the Subject Property is 4' -2" that requires exception for the proposed yard walls and gates on the basis that this is the only property that will be impacted by the service entrance to SAR. The proposed yard wall and gates are harmonious with the context of the site and will have a positive effect on the surrounding streetscapes.

Staff Response: Staff finds that this criterion is met. The design of the yard wall meets the Downtown & Eastside Historic District standards and has been designed in a manner that is sensitive to and compatible with the Garcia St streetscape.

RELEVANT CODE CITATIONS:

14-4.6 HISTORIC DISTRICTS

A. General Provisions

1. Purpose

In order to promote the economic, cultural, and general welfare of the people of Santa Fe and to ensure the harmonious, orderly, and efficient growth and development of the City, the Governing Body deems it essential to preserve the qualities relating to the history and culture of Santa Fe, maintain a harmonious outward appearance to preserve property values, and attract residents and tourists alike. The specific purposes of this section are to preserve qualities relating to the history of Santa Fe, such as the following:

- I. Continue the existence and preservation of historic areas and buildings;
- II. Continued construction of buildings in Santa Fe's historic styles; and
- III. General harmony as to architectural style, form, color, height, proportion, texture, and material between buildings of historic design and those of more modern design.

2. Conflicting Standards

I. Zoning District Regulations

All designated landmarks and all properties located in historic districts shall be subject to the regulations of the base zoning district in which they are located, except for height as regulated in Section 14-4.6E, *General Design Standards for All Historic Districts*. When the requirements of the base zoning district conflict with the requirements of this Section 14-4.6, *Historic Districts*, the more restrictive standard shall apply.

II. Multiple Overlay Regulations

When a designated landmark or property located in a historic district is also located within another overlay, and there is a conflict between the requirements of the historic district and the other applicable overlay district, the more restrictive standard shall apply.

5. Boundaries

- a. The boundaries for the historic districts are as shown on the Official Zoning Map and incorporated in this Code by reference.
- b. If the boundary line of a historic district bisects or crosses a property without

encompassing the entire lot, the applicable requirements of the historic district shall be as determined by the Planning and Land Use Director.

6. Design of Buildings

Full responsibility for the design and development of structures is upon the applicant. The case file of any prior application related to a property is available for review by the applicant upon request.

7. Nonconforming Buildings and Structures

Any building or structure in the historic district that does not meet the standards for architectural style outlined in this section shall be considered nonconforming, and subject to the provisions of Section 14-1.13(), *Legal Nonconforming Structures*, unless given special approval by the HDRB for architectural or historic interest, or unless individually entered in the state register of cultural properties or in the national register of historic places or designated as significant on either register.

B. Exceptions

The HDRB may grant an exception to the regulations set forth in this section, provided that such exception does not exceed the underlying zoning, except when the board of adjustment grants a variance. Staff shall determine whether an exception to general design and preservation standards described in Section 14-4.6E is required and shall recommend that the HDRB approve, approve with conditions, or deny the exception.

1. Height

If an applicant requests approval of a height in the historic district that exceeds the underlying zoning district requirement, the applicant shall first receive an exception to this section. If the HDRB approves a requested height exception, the applicant shall proceed to the Board of Adjustment or other applicable city body for consideration of the proposed variance, as described in Section 14-2.1H.1.

2. Design Standards

The HDRB may review and grant or deny requests for exceptions to all provisions of Section 14-4.6E, *General Design Standards for All Historic Districts* (except provisions regarding Height, Pitch, Scale, Massing, and Floor Stepbacks).

14-4.6G) for construction or alterations within the historic districts, and Section 14-7.61) for signs in historic districts. Exceptions are project-specific and do not apply to the subject property in perpetuity.

I. Procedure

When requesting exceptions, the applicant shall use the procedures for public notice and hearing in Section 0), unless the applicant also requests a variance to the underlying zoning. In such a case, the applicant for the historic ordinance exception shall not be required to publish a separate legal ad in the local newspaper. Publication of the agenda is still required.

II. Approval Criteria

To approve an exception, the HDRB shall make findings of fact that the applicant conclusively demonstrated that the requested exceptions comply with all the criteria listed as follows:

- a. Do not damage the character of the district;
- b. Are required to prevent a hardship to the applicant or an injury to the public welfare; and
- c. Strengthen the unique heterogeneous character of the City by providing a full range of design options to ensure that residents can continue to reside within the historic districts.

3. Height, Pitch, Scale, Massing, and Floor Stepbacks

The HDRB is responsible for reviewing and granting or denying requests for exceptions from regulations in Section 14-4.6F. The HDRB may grant exceptions and impose conditions thereon to Section 14-4.6F) for the height of structures within the historic districts as specified in Section 14-4.6F.1).

Exceptions are project-specific and do not apply to the subject property in perpetuity.

I. Procedure

When requesting exceptions, the applicant shall use the procedures for public notice and hearing in Section 0), unless the applicant also requests a variance to the underlying zoning. In such a case, the applicant for the historic ordinance exception shall not be required to publish a separate legal ad in the local newspaper. Publication of the agenda is still required.

II. Approval Criteria

To approve an exception, the HDRB shall make findings of fact that the applicant conclusively demonstrated that the requested exceptions comply with all the criteria listed as follows:

- a. Do not damage the character of the streetscape;
- b. Prevent a hardship to the applicant or an injury to the public welfare;
- c. Strengthen the unique heterogeneous character of the city by providing a full range of design options to ensure that residents can continue to reside within the historic districts;
- d. Are due to special conditions and circumstances which are peculiar to the land or structure involved and which are not applicable to other lands or structures in the related streetscape;
- e. Are due to special conditions and circumstances which are not a result of the actions of the applicant; and
- f. Provide the least negative impact with respect to the Purpose of this section as set forth in Section 14-4.6A.1.

C. General Design Standards for All Historic Districts

These standards shall apply to all additions or alterations to existing structures in the Historic Districts. Contributing, significant, and landmark structures may be subject to specific additional restrictions and district-specific standards in Section 14-4.6G).

I. General

- I. The historic status of a property with a historic status designation of significant, contributing, or landmark structure shall be retained and preserved. If a proposed alteration will cause a property to lose its significant, contributing, or landmark status, the application shall be denied. The removal of historic materials or alteration of architectural features and spaces that embody the status is prohibited.
- II. If a proposed alteration or new construction will cause an adjacent property to lose its significant, contributing, or landmark status, the application may be denied.
- III. For the regulations of this subsection, all facades of a significant structure are primary facades.

2. Building Additions

- I. Design
 - a. Building additions that meet the standards of Section 14-4.6G.2), *Downtown and Eastside Historic District*, shall continue to meet those standards, in addition to the standards set forth in this section.
 - b. Building additions shall have similar materials, architectural treatments and styles, features, and details as the existing structure, but shall be distinguishable from and not attempt to duplicate the existing structure.

- II. Size and Location
 - a. Building additions are not permitted on primary facades.
 - b. All building additions shall be set back a minimum of ten feet from the primary facade.
 - c. Building additions shall not exceed 50 percent of the square footage of the building's historic footprint and shall not exceed 50 percent of the historic length in linear feet of the primary facade.
 - d. To the extent architecturally practicable, new building additions shall be attached to any existing non-primary facade of a structure rather than attaching them to the primary facade of a structure.
- III. Height
 - a. The maximum height of building additions to significant and landmark structures shall be at least six inches lower than the parapet or equivalent roof feature of the existing adjacent connecting facade.
 - b. Building additions to contributing structures shall be no more than one additional story higher than the existing structure. To the extent architecturally practicable, two-story additions shall be set to the rear or the side rear of the structure. When an additional story is to be placed upon an existing contributing structure, that footprint may be no greater than fifty percent of the footprint of the existing structure, subject to the provisions of Subsection A(1) above. For the purposes of this paragraph, an additional story shall not exceed twelve (12) feet from the existing rooftop to the highest point of that story.
- IV. Remodeling to Increase Height
 - a. For remodeling of an existing significant or landmark structure, no increase in height of the structure is permitted.
 - b. For remodeling an existing contributing structure, a height increase may be permitted through approval of an exception, as described in Section 14-4.6D.
- V. Rooftop Equipment
 - Rooftop equipment, including but not limited to solar collectors, clerestories, decks, or mechanical equipment, may only be installed on contributing and noncontributing structures and shall not be publicly visible, nor shall a parapet be raised to conceal such equipment.
- 3. Porches and Portals
 - Existing porches or portals on significant and landmark structures, and on primary facades of contributing structures, shall not be permanently enclosed.

4. Windows, Doors, and Other Architectural Features

- I. For all facades of significant and landmark structures and for the primary facades of contributing structures:
 - a. Historic windows shall be repaired or restored wherever possible. Historic windows that cannot be repaired or restored shall be duplicated in the size, style, and material of the original. Thermal double-pane glass may be used. No window opening shall be widened or narrowed.
 - b. Window depth and other characteristics of window and door fenestration shall be preserved.
 - c. No new opening shall be made where one presently does not exist unless historic documentation supports its prior existence.
 - d. No historic opening shall be closed.
- II. For all facades of contributing, significant, and landmark structures:
 - a. Architectural features, finishes, and details other than doors and windows shall be repaired rather than replaced.
 - b. In the event replacement is necessary, the use of new material may be approved. The new material shall match the material being replaced in composition, design, color, texture, and other visual qualities.
 - c. Replacement or duplication of missing features shall be substantiated by documentation, physical, or pictorial evidence.

5. Roofs

The existing historic roof styles and materials shall be maintained or replaced in kind if necessary. The addition of dormers or other roof features should only be considered when they are an existing historic feature of the structure.

6. Surface Cleaning

The surface cleaning of structures shall employ the gentlest means possible. Chemical or physical treatments, such as sandblasting, that cause damage to historic materials are not permitted.

7. Archaeological Resources

Discovery of archaeological resources made during the development of a historic property shall be referred to the Archaeological Review Committee. See Section 14-2.1G.1.V.c, *Unexpected Discoveries*.

8. Signs

Sign applications and required submittals shall be reviewed by the Planning and Land Use Department. Approval or denial shall be indicated by the department on the application for the construction permit and on each of the required submittals.

D. Height, Pitch, Scale, Massing, and Floor Step backs.

The height, pitch, scale, and massing of any structure in a historic district, as defined in this section, shall be limited as provided for in this section, unless further restricted elsewhere within this chapter.

I. Applicability

The following sections identify specific areas and specific projects subject to this section. The Planning and Land Use Director shall determine whether or not properties are included within this section.

I. Specific Areas

The height limitations in this subsection F apply:

- a. Within the following historic districts:
 1. Downtown and Eastside;
 2. Don Gaspar Area;
 3. Historic Transition; and
 4. Westside-Guadalupe.
- b. In the Historic Review district, as specified herein. This authority shall apply to the northern and eastern portion of the Historic Review district, as illustrated on the map adopted by Ordinance No. 1983-69, and as amended, incorporated by reference, and shown on the Official Zoning Map. Inclusive under this authority are all properties accessed from Canyon Road, Camino Militar, Apodaca **Hill**, Camino Ribera, Camino Cabra, Camino Santander, Camino San Acacia, Camino del Monte Sol, Camino Rancheros, Camino Ranchitos, Garcia Street, Old Santa Fe Trail (to the Arroyo de los Chamisos crossing), and Old Pecos Trail (to the southern boundary of the Historic Review district) as they continue out of the Downtown and Eastside historic district and terminate in the Historic Review district. This authority shall also apply to all properties accessed from public rights-of-way that are located east of the western boundary of the Historic Review district and north of the southern boundary of the Historic Review district to the intersection of Camino Corrales and Fort Union Drive.
- c. To all properties accessed from Camino Lejo, Mt. Carmel Road, and east to the intersection of Camino de Cruz Blanca and Camino de Cruz Blanca Norte, inclusive of Camino de Cruz Blanca and Camino de Cruz Blanca Norte, and exclusive of properties east of the intersection of Camino de Cruz Blanca and Camino de Cruz Blanca Norte.
- d. The limitation of applicability shall not affect the authority of the HDRB with respect to significant or contributing structures as provided in Section 14-4.6G.1, *Don Gaspar Area Historic District*, Section 14-4.6G.3, *Historic Review District*, and Section 14-4.6G.4, *Historic Transition District*.

II. Streetscape Standards

- a. Streetscapes shall not extend beyond the outer boundaries of the historic

districts.

- b. When determining streetscape, the following structure types shall be excluded: institutional structures, buildings originally constructed to house a hotel, multi-unit residential, buildings with non-historic multiple stories, non-historic pitched roof, auxiliary outbuildings such as sheds, existing structures approved by way of a variance or exception, and yard walls and fences whose height is inconsistent with the predominant height of yard walls and fences on an applicable streetscape.
- c. When determining an applicable streetscape, vacant lots or parcels shall not be included in the calculation for allowable height.
- d. If a portion of a structure falls within the measurement of an applicable streetscape, such structure shall be considered as part of the applicable streetscape.
- e. If the determined allowable height of a proposed residential building or addition does not meet the minimum construction standards related to height set forth in the International Building Code (IBC), then the IBC shall prevail.

III. Project Location

Planning and Land Use Department staff shall determine the applicability of this section to individual projects and the applicable streetscape as follows:

- a. If the project is located on a street that extends linearly with no interruptions or truncations, the streetscape shall include buildings, yard walls, and fences on both sides of the street on which the proposed building, yard wall, or fence is to be located, for a distance of 600 feet measured from the midpoint of the street-facing facade(s) of the proposed building, yard wall, or fence in both directions parallel to the street centerline. See Figure 4.6-2.

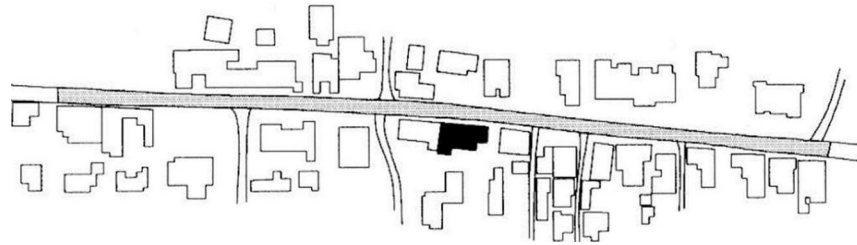

Figure 4.6-2: Linear Street - No Interruptions or Truncations

- b. If the streetscape is truncated by an intersecting block or a visual intrusion, such as a curve or turn in the streetscape, before the 600 feet is measured, the streetscape shall include all buildings, yard walls, or fences up to and including those which front the intersection or intrusion. See Figure 4.6-1.

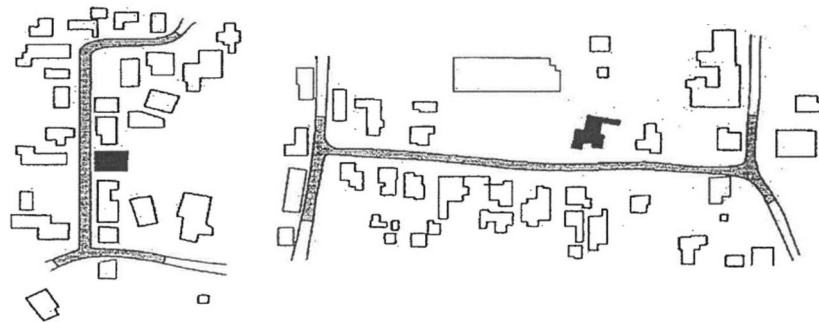

Figure 4.6-1: Truncation by an Intersecting Block or Visual Intrusion

- c. If the proposed building, yard wall, or fence fronts more than one street, the streetscape on each street frontage, as determined in provision 1 above in this subsection above, shall be considered. See Figure 4.6-3.



Figure 4.6-3: Frontage on More than One Street

- d. When the proposed building, yard wall, or fence is located on a lot with no frontage on rights-of-way, the streetscape is defined by measuring a distance of 300 feet in all directions beginning from the mid-point of the facade that contains the principal entrance of the building. The height of a proposed yard wall or fence shall not exceed the height of the tallest yard wall or fence within this streetscape. See Figure 4.6-4.

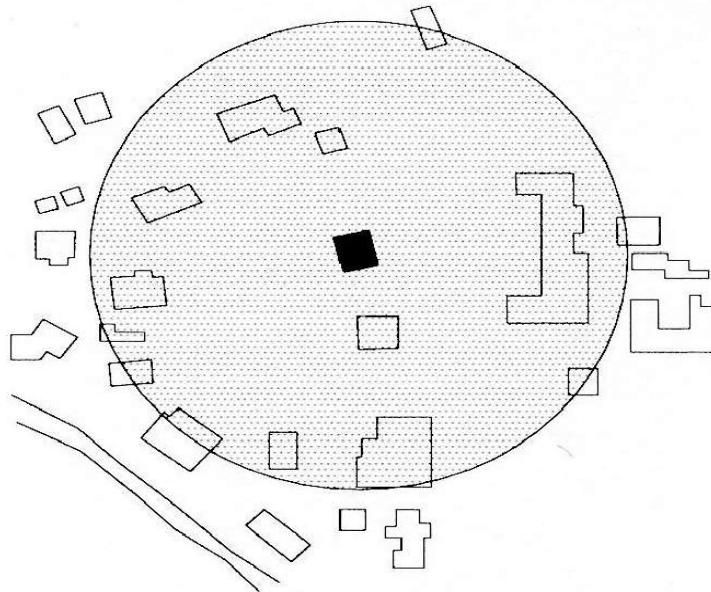

Figure 4.6-4: Interior Lot with No Street Frontage

- e. When the proposed building, yard wall or fence faces a T- or a Y- intersection, the streetscape shall include buildings, yard walls, and fences as defined in provision 1 above this subsection, and buildings, yard walls, and fences on both sides of the street creating the leg of the "T" or the arm of the "Y" for a distance of 300 feet parallel to the street centerline. See Figures 4.6-5 and 4.6-6.

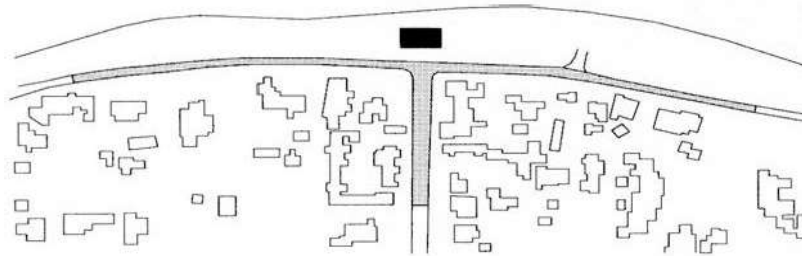

Figure 4.6-5: Location at a 'T' Intersection

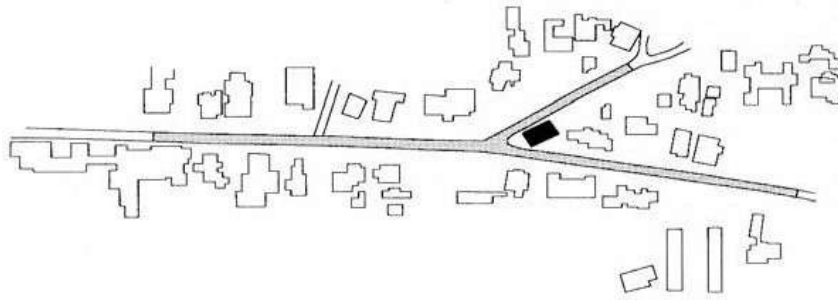

Figure 4.6-5: Location at a "Y" Intersection

- f. When the proposed building, yard wall, or fence is located in a streetscape that includes no buildings, yard walls, or fences, the height of the proposed building shall not exceed 16 feet. Yard walls and fences in this streetscape shall not exceed five feet in height.

2. Height

- I. Official Map of Building Heights in the Historic Districts - Procedures
 - a. The HDRB shall recommend the adoption of an official map reflecting building heights in the historic districts to the Governing Body. This map shall be used to regulate building height in the historic districts. The official map, adopted January 2010 inclusive of amendments, is hereby adopted by reference and incorporated as if set out herein.

- b. The map shall be adopted at a public hearing of the Governing Body, which hearing shall be advertised in a local newspaper no less than 15 days prior to the hearing. All affected property owners and owners of lots or of land within 100 feet, excluding public right-of-way, of the property affected shall be notified of the public hearing by first-class mail, postmarked at least 15 days before the public hearing. The official map shall be adopted by the Governing Body by ordinance.
- c. The official map of building heights in the historic districts may be amended from time to time. The HDRB shall make recommendations to the Governing Body for the amendment of the official map at a public hearing. Such hearing shall be advertised in a local newspaper no less than 15 days prior to the hearing.
- d. The Governing Body shall hold a public hearing on any amendments to the official map. Such a public hearing shall be advertised in a local newspaper no less than 15 days prior to the hearing. All affected property owners and owners of lots or of land within 100 feet, excluding public right-of-way, of the property affected shall be notified of the public hearing by first-class mail, postmarked at least 15 days before the public hearing.
- e. The official map is available in the Planning and Land Use Department and is accessible at all reasonable times for inspection.

II. Height Limitations

The HDRB shall limit the height of structures as set forth in this section. Heights of existing structures shall be as set forth on the official map of building heights in the historic districts.

- a. If a proposed building has a parapet, the façade shall not exceed two feet of the average of the height of the façades in the streetscape.
- b. If the proposed building has a pitched roof, the ridge height of the proposed building shall not exceed two feet of the average of the ridge height of the pitched roofs in the streetscape.
- c. Yard walls and fences shall be limited to a height that does not exceed the average of the height of other yard walls and fences in the streetscape.
- d. The height of any other structure shall be limited to the allowable building height within the applicable streetscape, as defined in this section.
- e. The height and dimension of signage are as set forth in Section 14-7.61), *Sign Regulations in the Historic Districts*.
- f. The HDRB may increase the allowable height for proposed buildings and additions located on a sloping site where the difference in the natural grade along the structure's foundation exceeds two feet. In no case shall the height of a façade exceed four feet above the allowable height of the applicable streetscape measured from natural or finished grade, whichever is more restrictive. This increase in height shall be constructed only in the form of

building setbacks from the street.

III. Height Measurement

- a. In historic districts, height shall be the vertical distance measured between the highest part of a structure and the existing grade or finished grade, whichever is more restrictive, at the midpoint of the street-facing facade, excluding rooftop appurtenances, the increased height of walls or fences over pedestrian and vehicular openings, and gates (either in open or closed position).
- b. For structures that do not have street frontage, height shall be determined by the facade that contains the tallest vertical distance measured between the highest part of a structure and the existing grade or finished grade, whichever is more restrictive. The height of walls and fences is measured from the street-facing side of the wall or fence.

IV. Pitch

If the determined streetscape includes over 50 percent buildings with pitched roofs, the proposed building may have a pitched roof. A pitched roof is defined as a gable, shed, or hipped roof. The pitch of the roof shall match the predominant pitch extant in the streetscape.

V. Scale

The height of a proposed building or addition, its façade length, and its roof form and pitch shall appear to be in proportion to the height, façade length, and roof form and pitch of buildings in the applicable streetscape, or the building on which the addition is proposed.

VI. Massing and Floor Stepbacks

The HDRB may require that upper floor levels be stepped back, to carry out the intent of this section; provided that the HDRB in making such determinations shall take into account whether the height of the proposed building, yardwall, fence, or proposed stepback of upper floor levels is in harmony with the massing of the applicable streetscape and preservation of the historic and characteristic visual qualities of the streetscape. The HDRB shall also require that the publicly visible facades of the structure be in conformance with Section 14-4.6G), *Additional District-Specific Design Standards*, and in meeting those requirements, may require that different floor levels be stepped back.

E. Additional District-Specific Design Standards

2. Downtown and Eastside Historic District

The governing body recognizes that a style of architecture has evolved within the city from the year 1600 to the present characterized by construction with adobe, hereafter called "old Santa Fe style", and that another style has evolved, hereafter called "recent Santa Fe style", which is a development from, and an elaboration of the old Santa Fe style, with different materials and frequently with added decorations.

I. Old Santa Fe Style

Old Santa Fe style, characterized by construction with adobe, is defined as including the so-called "pueblo" or "pueblo-Spanish" or "Spanish-Indian" and "territorial" styles and is more specifically described as follows:

- a. With rare exception, buildings are of one story, few have three stories, and the characteristic effect is that the buildings are long and low. Roofs are flat with a slight slope and surrounded on at least three sides by a firewall of the same color and material as the walls or of brick. Roofs are never carried out beyond the line of the walls except to cover an enclosed portal or porch formed by setting back a portion of the wall or to form an exterior portal, the outer edge of the roof being supported by wooden columns.
Two-story construction is more common in the territorial than in other sub-styles, and is preferably accompanied by a balcony at the level of the floor of the second story. Facades are flat, varied by inset portales, exterior portales, projecting vigas or roof beams, canales or water-sprouts, flanking buttresses and wooden lintels, architraves and cornices, which, as well as doors, are frequently carved, and the carving may be picked out with bright colors. Arches are almost never used except for nonfunctional arches, open slightly ogive, over gateways in freestanding walls.
- b. All exterior walls of a building are painted alike. The colors range from a light earth color to a dark earth color. The exception to this rule is the protected space under portales, or in church-derived designs, inset panels in a wall under the roof, in which case the roof overhangs the panel. These spaces may be painted white or a contrasting color or have mural decorations.
- c. Solid wall space is always greater in any façade than window and door space combined. Single panes of glass larger than thirty (30) inches in any dimension are not permissible except as otherwise provided in this section;
- d. The rules as to flat roofs shall not be constructed to prevent the construction of skylights or installation of air conditioning devices, or any other necessary roof structures, but such structures other than chimneys, flues, vents and aerials, shall be so placed as to be concealed by the firewall from the view of anyone standing in the street on which the building fronts;
- e. True old Santa Fe style buildings are made of adobe with mud plaster finish. Construction with masonry blocks, bricks, or other materials with which the adobe effect can be simulated is permissible, provided that the exterior walls are not less than eight (8) inches thick and that geometrically straight façade lines are avoided. Mud plaster or hard plaster simulating adobe, laid on smoothly, is required; and
- f. It is characteristic of Old Santa Fe style commercial buildings to place a portal so that it covers the entire sidewalk, the columns being set at the curb line.

II. Recent Santa Fe Style

Recent Santa Fe style intends to achieve harmony with historic buildings by retention of a similarity of materials, color, proportion, and general detail. The dominating effect is to be that of adobe construction, prescribed as follows:

- a. No building shall be over two stories in height in any façade unless the façade shall include projecting or recessed portales, setbacks, or other design elements;
- b. The combined door and window area in any publicly visible façade shall not exceed forty percent of the total area of the façade except for doors or windows located under a portal. No door or window in a publicly visible façade shall be located nearer than three (3) feet from the corner of the façade;
- c. No cantilevers shall be permitted except over projecting vigas, beams, or wood corbels, or as part of the roof treatment described below;
- d. No less than eighty percent of the surface area of any publicly visible façade shall be adobe finish, or stucco simulating adobe finish. The balance of the publicly visible façade, except as above, may be of natural stone, wood, brick, tile, terra cotta, or other material, subject to approval as hereinafter provided for building permits;
- e. The publicly visible façade of any building and of any adjoining walls shall, except as otherwise provided, be of one color, which color shall simulate a light earth or dark earth color, matte or dull finish, and of relatively smooth texture. Facade surfaces under portales may be of contrasting or complementary colors. Windows, doors, and portals on publicly visible portions of the building and walls shall be of one of the old Santa Fe styles, except that buildings with portals may have larger plate glass areas for windows under portals only. Deep window recesses are characteristic, and
- f. Flat roofs shall have not more than thirty (30) inches overhang.