



# City of Santa Fe, New Mexico

200 Lincoln Avenue, P.O. Box 909, Santa Fe, N.M. 87504-0909  
www.santafenm.gov

*Alan Webber, Mayor*

Councilors:

- Signe I. Lindell, Mayor Pro Tem, District 1
- Alma G. Castro, District 1
- Michael J. Garcia, District 2
- Carol Romero-Wirth, District 2
- Lee Garcia, District 3
- Pilar F.H. Faulkner, District 3
- Jamie Cassutt, District 4
- Amanda Chavez, District 4

**Date:** January 5, 2026

**To:** Mayor Michael Garcia and Governing Body  
Public Works and Utilities Committees, Finance

**Via:** Brian Moya, Interim City Manager

BM  
BM

**From:** Jimmy Gunn, Interim Director, Santa Fe Regional Airport

JG  
JG

Terry Lease, Asset Development Manager, Asset Development

TL  
TL

**Subject:** Lease Agreement for ARINC Incorporated for Terminal Space at Santa Fe Regional Airport

**ITEM AND ISSUE:**

The Santa Fe Regional Airport respectfully requests your review and approval of a lease agreement for terminal space between the City of Santa Fe (Santa Fe Regional Airport) and ARINC Incorporated; (Jimmy Gunn, [jgunn@santafenm.gov](mailto:jgunn@santafenm.gov); Terry Lease, [tjlease@santafenm.gov](mailto:tjlease@santafenm.gov)).

**BACKGROUND AND SUMMARY:**

The City of Santa Fe (“City” or “Lessor”) owns and operates the Santa Fe Regional Airport (“Airport”) in the City of Santa Fe, County of Santa Fe, State of New Mexico. Lessor allows Lessee the following “Premises”: 36 square feet of space in the Terminal IT/Data Room and 27 square feet of surface space on the roof of the Terminal. Lessee shall use Premises solely for the purpose of providing air/ground communication services to tenants of the Airport. Lessee provides a shared wide area network service providing a single connection for airlines’ self-serve passenger check-in systems and back-office systems into a global network.

The initial term of the proposed Lease is five (5) years, with two (2) option terms of five (5) years each. The base rent shall be \$6,408.00 per year (\$534.00 per month) and shall escalate at 2.0% per year.

**PRIOR APPROVALS AND SUPPORTING INFORMATION:**

**FUNDING SOURCE:**

**Munis Org Name/Number:** Airport/5456050

**Munis Object Name/Number:** Land-rentals/460150

**Budget Officer / Designee:** Andy Hopkins **Date:** 01/05/2026

**Budget Officer Comment/Exceptions:** \_\_\_\_\_

**PROCUREMENT METHOD:**

The procurement method used was NMSA 1978, Section 13-1-98, Exempt

Leases are exempt from Procurement.

**Chief Procurement Officer (CPO) / Designee:** N/A Exempt **Date:** \_\_\_\_\_

**CPO Comment/Exceptions:** \_\_\_\_\_

**ASSOCIATED APPROVALS:**

**IT Components included?**  Yes |  No

**Approval:** \_\_\_\_\_ **Title:** \_\_\_\_\_ **Date:** \_\_\_\_\_

**Comment/Exceptions:** \_\_\_\_\_

**Vehicles included?**  Yes |  No

**Approval:** \_\_\_\_\_ **Title:** \_\_\_\_\_ **Date:** \_\_\_\_\_

**Comment/Exceptions:** \_\_\_\_\_

**Construction to City Facilities, Furniture, and/or Fixtures included?**  Yes |  No

**Approval:** \_\_\_\_\_ **Title:** \_\_\_\_\_ **Date:** \_\_\_\_\_

**Comment/Exceptions:** \_\_\_\_\_

**Is this an externally funded purchase?**  Yes |  No

**If yes, what is the issuing agency:** \_\_\_\_\_

**Approval:** \_\_\_\_\_ **Title:** \_\_\_\_\_ **Date:** \_\_\_\_\_

**Comment/Exceptions:** \_\_\_\_\_

**Is this a Capital Asset or Project?**  Yes |  No

**Project Ledger Number:** \_\_\_\_\_

**Approval:** \_\_\_\_\_ **Title:** \_\_\_\_\_ **Date:** \_\_\_\_\_

**Comment/Exceptions:** \_\_\_\_\_

**ATTACHMENTS:**

- Lease Agreement
- Certificate of Insurance
- Real Property Determination

ITEM # \_\_\_\_\_

**LEASE AGREEMENT BETWEEN  
THE CITY OF SANTA FE AND ARINC INCORPORATED**

This LEASE AGREEMENT (“Lease Agreement”) is made and entered into as of the date of the last signature (“Effective Date”), by and between the CITY OF SANTA FE, a municipal corporation (“City” or “Lessor”) and ARINC Incorporated, a Delaware corporation (“Lessee”), collectively the “Parties.”

**WHEREAS**, the City owns and operates the Santa Fe Regional Airport (“Airport”) in the City of Santa Fe, County of Santa Fe, State of New Mexico; and

**WHEREAS**, operations at the Airport are subject to laws, rules, and regulations including Chapter 3 of the Santa Fe City Code of 1987 and the rules, fees, and minimum standards adopted thereunder; Chapter 64 of the New Mexico Statutes Annotated 1978 compilation, especially Article 1; 14 C.F.R. Parts 139, 158, and 170; and Federal Aviation Administration (“F.A.A.”) grant assurances, Order 5190.6B on airport operations as updated, and policies including those on airport revenue use (64 C.F.R. 7715, as amended) and hangar use (81 F.R. 38910, as amended); and

**WHEREAS**, services provided by Airport tenants benefit general aviation at the Airport, commercial aviation operators and passengers, and residents of the City and of Santa Fe County; and

**WHEREAS** the City operates a terminal building on the Airport known as Santa Fe Regional Airport Terminal (“Terminal”), located on the Airport at the end of Aviation Drive, Santa Fe, New Mexico for the purpose of providing safe and reliable air transportation services and supporting travel amenities; and

**WHEREAS**, Lessee wishes to provide air/ground communication services, including and not limited to, airlines’ self-serve passenger check-in systems and back office systems at the Airport; and

**WHEREAS**, the City desires to lease a portion of the Terminal and Terminal roof to Lessee for the purpose of providing air/ground communication services to tenants of the Airport.

**WITNESSETH:**

In consideration of the Lessee’s promises herein, Lessor hereby gives Lessee a Lease Agreement, revocable and terminable as hereinafter provided, to enter on, make use of, and develop the real property of Lessor as follows:

**1. PREMISES**

Lessor allows Lessee to use, occupy, subject to the terms and conditions of this Lease Agreement, the following (collectively the "Premises."):

- a. The Premises consists of approximately of 36 total square feet, 9 square feet of floor space in the Terminal IT/Data Room and 27 square feet of surface space on the roof of the Terminal, to include air space above the roof (collectively "**Terminal Space**") as shown on **Exhibits A and B** respectively of this Lease Agreement.
- b. Lessee acknowledges that the Premises is necessary to serve the primary use and, that to the extent the City Terminal, or any portion thereof, is used by Lessee, such use is on a secondary and non-exclusive basis.
- c. The installation, location and maintenance, at Lessee's sole cost and expense, of identifying signs in the Premises shall be subject to the prior written approval of the Airport Director, which approval shall not be unreasonably withheld, conditioned, or delayed. The general type and design of such signs shall be harmonious and in keeping with the pattern and decor of the Airport.
- d. In the event that the City requires the Premises for its own use, or any portion thereof, City may require that Lessee relocate all or a part of its air/ground communication equipment. In such event, City shall notify Lessee in writing 90-days prior to the date that City requires use of the Premises and Lessee shall complete the relocation of the air/ground communication equipment within this period ("Relocation Period"). If the Parties are unable to agree on a relocation site during the first 30-days of the Relocation Period, then either Party may terminate this Lease Agreement.
- e. Lessee accepts the Premises in its present state and agrees that it is in good condition, without any representation or warranty by Lessor as to the condition of the Premises.

## 2. LEASE TERM

- a. Initial Term. The initial term of this Lease Agreement shall commence at 12:00 a.m. on the Effective Date. The term of this Lease Agreement shall consist of an "Initial Term" of five (5) years, with two (2) "Option Terms" of five (5) years each.
- b. Option Term. Lessee's exercise of any Option Term is contingent upon compliance with this Lease Agreement and with proper written notice by Lessee to Lessor at least ninety (90) days prior to the expiration of the Initial Term and approval or denial of any Option Term shall be at the sole discretion of Lessor's Airport Director. All terms, covenants and conditions of this Lease Agreement, excepting the amount of rent to be paid, shall remain in full force and effect during any extension of the term.
- c. Hold Over. In the event Lessee remains in possession of the Premises after the expiration of the Term of this Lease Agreement, such possession may, at the sole option of Lessor's Airport Director, be continued as a month-to-month tenancy. During any such month-to-month tenancy, the Rent due shall be prorated and payable on a monthly basis, and the terms and conditions of the Lease Agreement shall be otherwise applicable.

### 3. RENT AND FEES

- a. Base Rent. Lessee shall pay to Lessor first year Rent for the Terminal Space of \$534.00 per month, \$6,408.00 per year (36sq.ft. x \$178.00/sf/year).
- b. Payment of Rent. Lessee shall pay Base Rent monthly, which is due on the Effective Date and thereafter due in full on the first day of each month during the Term without notice or demand and without deduction or offset for any cause whatsoever. Lessee shall make payments to; City of Santa Fe, Treasury Division, 200 Lincoln Ave., Room 114, Santa Fe, NM, 87504.
- c. Penalty for Late Payment. If money payable to Lessor as a condition of this Lease Agreement is not paid in full when due, a penalty of 10% of the amount due and unpaid shall be added to the amount due, and the total sum of the then-due rental payment plus penalty shall become immediately due and payable to Lessor. A further penalty of 10% of the amount due and unpaid, including previously assessed penalties, shall be added for each additional month that said amount remains unpaid. The assessment and collection of the 10% penalty is in addition to any other rights of Lessor, if Lessee does not faithfully perform the terms, covenants and conditions of this Lease Agreement.
- d. Rent Schedule. In consideration of this Lease Agreement, City and Lessee agree to the Rent Schedule attached as **Exhibit C**.
- e. Increase in Rent. Rent shall be increased annually, effective on the first anniversary of the Rent Commencement Date and annually thereafter. Annual increases in Rent shall be based on the attached Rent Schedule.

### 4. USE OF PREMISES

- a. Conditions of Use. Lessee shall use the Premises solely for the purpose of providing air/ground communication services to tenants of the Airport. Lessee provides a shared wide area network service providing a single connection for airlines' self-serve passenger check-in systems and back office systems into a global network. Lessee may:
  - i. With prior written consent of Lessor, Lessee may construct, install, maintain, repair, and operate air/ground communication equipment, radios, antennas, cables, and accessories in and on the Premises (collectively "Communications Equipment"), and perform such other acts as are reasonably necessary to carry out the permitted uses.
  - ii. Make modifications to the Communications Equipment, other than like-for-like replacements, only with prior written approval by Lessor's Airport Director, which approval shall not be unreasonably withheld, conditioned or delayed.
  - iii. Lessee may make like-for-like replacements and repairs of the Communications Equipment without Lessor's consent and subject to written notice from Lessee delivered fifteen (15) days in advance.
  - iv. Notwithstanding the previous paragraph, if Lessee's equipment fails or has more than 10% down time in any three (3) day period, Lessee may replace equipment like-for-like and Lessee shall provide notice of the repair and details regarding replacement equipment without unnecessary delay to Lessor's Airport Director.
- b. Access to the Premises. City grants to Lessee the following:
  - i. City grants to Lessee non-exclusive vehicular and pedestrian access for ingress and egress over and on the Airport and Terminal.

- ii. Lessee's shall at all times have two (2) staff members approved for an SAF Identification Media Badge ("Badge"). Lessee's staff is required to apply for and obtain a Badge in order to access the Premises. Lessee's staff shall have a Badge on their person at all times or access to the Premises will be denied. Lessee's badged employees may escort up to two non-badged invitees pursuant to applicable federal and SAF rules and regulations.
  - iii. In lieu of badging staff members, Lessee may access the Premises during all hours and days that the Airport is open for business by arranging access and escort in advance with Airport staff. Such scheduling of access shall be at a time mutually agreed upon by the Parties and for each such hour of access that Lessee requires escort, Lessee shall pay the Airport an escort fee of \$75.00 per hour.
- c. Improvement of the Premises.

Lessee may, with the prior written consent of Lessor's Airport Director and at no cost to Lessor, make improvements to the Premises which are required to comply with the City of Santa Fe Land Use Code and other applicable local, state and federal regulations. Lessee shall, upon Lessor's request, remove all such improvements made to the Premises at the termination of this Lease Agreement.
- d. Trade Fixtures. All trade fixtures installed by Lessee after the Effective Date of this Lease Agreement shall remain the property of Lessee, who may remove the same upon termination of this Lease Agreement, provided that removal shall be done in such a manner as not to injure or damage the Premises. In the event that Lessee fails to remove said trade fixtures after receipt of notice from Lessor to do so, Lessor may remove and dispose of the same as it sees fit and Lessee agrees to sell, assign, transfer and set over to Lessor all of Lessee's right, title and interest in and to said trade fixtures and any personal property not removed by Lessee. Lessee further agrees that should Lessor remove said trade fixtures pursuant to this paragraph, that Lessee shall pay Lessor upon demand the cost of such removal, plus the cost of transportation and disposal thereof.
- e. Compliance with Laws. Lessee's use of the Premises shall at all times be in compliance with the City of Santa Fe Municipal Code and other applicable local, state and federal regulations including but not limited to compliance with the City of Santa Fe Integrated Pest Management Policy (§ 10-7 SFCC 1987) (the Pest Management Policy).
- f. Interference. Lessee shall not cause harmful material interference with equipment at the Airport or with any radio communications where such communications are operated within their respective frequencies, in accordance with all applicable laws and regulations. In the event that any of Lessee's equipment causes such interference, and after Lessor has notified Lessee in writing of such interference, Lessee shall take all commercially reasonable steps necessary to correct and eliminate the interference, including and not limited to, at Lessee's option, powering down such equipment and later power up such equipment for intermittent testing. If Lessee, after having taken all commercially reasonable steps necessary to correct and eliminate the interference, is unable to permanently correct and eliminate the interference to the Lessor's reasonable satisfaction with 10-days of Lessee's receipt of written notice of such interference, Lessor may in its sole discretion terminate this Lease Agreement by delivering written notice of termination to Lessee.

## **5. REPAIRS & MAINTENANCE**

- a. During the term of this Lease and any extension or renewal thereof, Lessee shall not cause or permit any waste, damage or injury to the Premises or to any improvements made to the Premises.
- b. During the term of this Lease and any extension or renewal thereof, Lessee shall, at its sole expense, keep and maintain the Premises in good and clean condition at all times and shall be responsible for the costs of any and all required repairs, replacements, and capital improvements that arise during the Term of this Lease Agreement. Lessee's responsibility to maintain and repair the Premises, excluding any repairs, replacements, and capital improvements to any structural elements of the Premises and any integrated building systems such as the mechanical, plumbing or electrical systems, all of which are reserved to Lessor unless such repairs are necessitated by the intentional conduct or negligence of Lessee and its employees, contractors, or other individuals or businesses acting on Lessee's behalf.
- c. Repairs and replacements required to be made by the Lessee shall be made promptly as and when necessary and shall be at least equal in quality of materials and workmanship to that originally existing in the Premises.
- d. Lessee shall at all times During the term of this Lease and any extension or renewal thereof, and in a timely manner, provide a safe Premises by eliminating conditions caused by, including and not limited to, snow, ice, debris, mold and standing water.
- e. Lessor reserves the right to inspect the Premises at any time during the Term of this Lease Agreement to verify Lessee's compliance with this Section 5. In the event Lessee fails to maintain the Premises at a standard acceptable to the Lessor's Airport Director, as determined in the Airport Director's sole discretion, Lessor may terminate this Lease Agreement in accordance with Section 13 herein.
- f. Repair and maintenance shall be to the sole satisfaction of Lessor's Airport Director, and if Lessee fails to fulfill any duty imposed under this Section 5 (Repairs and Maintenance) within a reasonable period of time, City may, at the discretion of the Airport Director, perform those duties at Lessee's sole cost. Lessee shall promptly cooperate with Lessor if Lessor undertakes to perform such duties. No action by Lessor taken pursuant to this Section 5 shall constitute a waiver of Lessee's obligations. Lessee's obligations under this Section 5 shall survive the expiration or termination of this Lease Agreement.

## **6. UTILITIES & SERVICES**

- a. Lessee, at Lessee's sole cost and expense, agrees to provide phone, internet, refuse disposal services and other related services.
- b. Lessor, at Lessor's sole cost and expense, agrees to provide the following:
  - i. Electricity.
  - ii. Pest control services.
  - iii. Snow removal services.

## **7. TAXES**

Lessee shall pay all taxes levied and assessed, if any, upon any personal property, fixtures and improvements belonging to Lessee and located upon the demised Premises, and all leasehold and possessory interest taxes levied or assessed by any proper taxing authority.

## 8. SUBLEASE, ASSIGNMENT OR TRANSFER

Lessee shall not sublet, assign or otherwise transfer this Lease Agreement, without the prior written consent of Lessor's Airport Director, which the Airport Director may withhold for any or no reason. Any such actions taken by Lessee without Lessor's consent shall result in the immediate termination of this Lease Agreement. Notwithstanding the foregoing, Lessor's consent to an assignment of this Lease shall not be unreasonably withheld so long as the assignment is to Lessee's corporate parent, or a subsidiary or affiliate of Lessee or Lessee's parent, or by way of merger, operation of law, or related to the sale of all or substantially all of the assets or stock of the Lessee to a third party.

## 9. INSURANCE

Lessee shall at all times maintain and provide adequate insurance coverage which includes, without limitation, each of the following:

- a. Property Insurance. Lessee shall carry and maintain in full force and effect during the term of this Lease Agreement casualty insurance ("extended coverage" and "additional extended coverage") as may be available for all improvements to the Premises in an amount sufficient to restore and replace existing structures and improvements if lost or damaged by any form of casualty. Lessee shall cause the City of Santa Fe to be named as an additional insured on such policy of insurance.
- (A) Commercial General Liability Insurance which shall be written on an occurrence basis and be at least as broad as the latest version of ISO form CG 00 01 with limits of not less than \$1,000,000 per occurrence and \$2,000,000 in the aggregate for claims against bodily injury, personal and advertising injury, and property damage. Such policy shall include Broad Form Contractual Liability coverage and shall be endorsed to include the City, its directors, officials, officers, employees, agents, and volunteers as additional insureds on all primary and excess policies for ongoing and completed operations performed by, or behalf of Contractor. Such additional insured coverage shall be as broad as that provided by ISO form CG 2010 (ongoing operations) and CG 20 37 (completed operations).
2. Workers' Compensation Insurance with statutory limits, and **Employer's Liability insurance** with limits of not less than \$1,000,000 per accident or disease. The Workers' Compensation policy shall be endorsed with a waiver of subrogation in favor of the City, its directors, officials, officers, employees, agents, and volunteers.
- b. Certificates of Insurance. Prior to the Effective Date of this Lease Agreement, and thereafter annually during the Term of this Lease Agreement that Lessor's Airport Director requests, Lessee shall provide Lessor with certificates of insurance for each policy evidencing that the coverage required hereunder is current. Such policy shall provide that the coverage evidenced thereby shall not be terminated or modified for any reason without thirty (30) days prior written notice to the Lessor.

## 10. INDEMNIFICATION

Lessee shall indemnify, hold harmless and defend Lessor from all losses, damages, claims or judgments, including payment of all reasonable attorney's fees, and costs, on account of any suit, judgment, execution, claim, action or demand whatsoever arising from damages occurring on the Premises and Lessee's use of the Premises hereunder, including use of the Premises by Lessee's employees, agents, representatives, contractors, agents, guests, invitees or permitted assigns.

Lessee shall cause any and all agreements that Lessee enters into with any of the above parties to contain language indemnifying Lessor as provided in this Section.

## 11. NEW MEXICO TORT CLAIMS ACT

Any liability incurred by Lessor in connection with the Lease Agreement is subject to the immunities and limitations of the New Mexico Tort Claims Act, Section 41-4-1, et seq. NMSA 1978, as amended. The City and its "public employees" as defined in the New Mexico Tort Claims Act, do not waive sovereign immunity, do not waive any defense, and do not waive any limitation of liability pursuant to law. No provision of this License modifies or waives any provision of the New Mexico Tort Claims Act.

## 12. EASEMENTS

Lessor reserves the exclusive right to grant access, utility or other easements on or through the Premises. Lessor shall notify Lessee in writing prior to Lessor's grant of any easement through the Premises.

## 13. TERMINATION

- a. Lessor may terminate this Lease Agreement upon Lessee's failure to comply with any provisions contained herein. Prior to termination, Lessor's Airport Director shall hand deliver or mail notice to Lessee via certified or registered mail specifying:
  - i. the breach;
  - ii. the action required to cure the breach;
  - iii. a date, not less than fifteen (15) days from the date the notice is hand delivered or mailed to Lessee, by which such breach must be cured; and
  - iv. that failure to cure such breach on or before the date specified in the notice will result in termination of the Lease Agreement.
- b. Either Party may terminate this Lease Agreement with written notice to the other Party at least ninety (90) days prior to the termination date.
- c. Removal and Restoration.
  - i. All portions of Lessee's Communications Equipment brought onto the Premises, Terminal and Airport by Lessee constitutes Lessee's personal property and Lessee may, in Lessee's sole discretion, remove any part any part of its Communications Equipment at any time during the Term of this Lease Agreement, or any extension thereof, or the removal period set forth herein in any way that does not damage the Premise, Terminal or Airport.
  - ii. All costs and expenses for the removal and restoration to be performed by Lessee under this Section shall be done by Lessee. Should Lessee fail to complete the removal and

restoration within the required time period, Lessor may complete such work and charge Lessee the reasonable cost thereof.

- d. At the termination of this Lease Agreement Lessee shall surrender the Premises in the condition in which they were at the inception of this Lease Agreement, excepting:
  - i. Deterioration caused through reasonable use and ordinary wear and tear;
  - ii. Alterations, improvements or conditions made with written approval by Lessor's Airport Director.

#### **14. RIGHTS OF LESSOR**

- a. Operate the Airport in the best interest of the public and the right, without interference or hindrance, to maintain, improve, or further develop the landing area or public use facilities of the Airport as it sees fit, regardless of any protest of the Lessee, and to lease additional space to other concessions at the Airport regardless of any objection of the Lessee. The Lessor may relocate the Lessee if the physical development of the Airport or the Airport Terminal requires relocation of the Lessee, provided the Lessor's Airport Director gives ninety (90) days' written notice to the Lessee and the Lessor compensates the Lessee for the Premises in one of the two following methods, at the Lessor's expense:
  - i. If Lessor's Airport Director determines it has another location available at the Airport or in the Terminal which is generally comparable in location to that being taken for development, then the Lessee shall relocate the Lessee-owned facilities to the new location in substantially similar form to that then existing. Lessee shall approve the new location for compliance with Lessee's technical requirements for operation of Lessee's equipment, which approval shall not be unreasonably withheld, delayed, or conditioned. In the event the parties are not able to locate a mutually-agreeable new location before the date provided by the notice of relocation, Lessor may take reasonable measures to remove and safely store Lessee's equipment while a mutually-agreeable new location is found. The Lessor shall reimburse Lessee within sixty (60) days for Lessee's actual expenses of relocation of its facilities, subject to prior written approval of the reasonableness of such expenses by Lessor's Airport Director; or
  - ii. If Lessor's Airport Director determines in the Airport Director's sole discretion that Lessee cannot be relocated as described above, then Lessor shall purchase from Lessee the Lessee-owned facilities to which title shall then pass in fee simple to Lessor. The amount to be paid by Lessor to Lessee shall be the fair market value of the improvements taken.
- b. Enter upon the Premises at any reasonable time for the purpose of making any inspection it may deem expedient to the proper enforcement of any of the covenants or conditions of this Lease and any federal, state, or city laws, ordinances, regulations, rules, and codes now or hereafter in effect.
- c. Lessor may tow at Lessee's expense any vehicle owned or rented by Lessee that is not parked in the Ready/Return, Parking Lot, or other area approved in writing by the Airport Director.

#### **15. RIGHTS OF LESSEE**

- a. Lessee shall have the right, but shall not be required:

- i. To the non-exclusive use, in common with others, of the Airport, appurtenances, and improvements thereon, but this shall not restrict the right of the Lessor to charge visitors a fee for the use of such areas;
  - ii. To install, operate, maintain, repair and store, subject to approval of Lessor's Airport Director in the interests of safety and the convenience of all concerned, all equipment necessary for the conduct of Lessee's business; and
  - iii. Of access to and from the Premises, limited to streets, driveways, and sidewalks designated for such purposes by the Lessor, and which right shall extend to Lessee's employees, passengers, guests, and patrons.
- b. Lessee is authorized, but not required, to provide the services set forth above in Section 4 (Use of Premises).

**16. NOTICE**

Any required notice will be deemed delivered, given and received (i) when personally hand delivered, or (ii) five days after the same are deposited in the United States mail, postage prepaid, registered, addressed to the applicable party at the address indicated below for such party, or at such other address as may be designated by either party in a written notice to the other party:

To Lessor:	City of Santa Fe Attn. City Manager P.O. Box 909 Santa Fe, NM 87504	To Lessee:	ARINC, Incorporated Attn. Real Estate Dept. 2551 Riva Road Annapolis, MD 21401-7435
------------	--	------------	--

With a copy to: City of Santa Fe  
Attn. Airport Director  
P.O. Box 909  
Santa Fe, NM 87504

City of Santa Fe  
Attn. Asset Development Manager  
P.O. Box 909  
Santa Fe, New Mexico 87504

**17. NO WAIVER**

No waiver of a breach of any of the provisions contained in this Lease Agreement shall be construed to be a waiver of any succeeding breach of the same or any other provisions.

**18. SEVERABILITY**

In the event that one or more of the provisions contained in this Lease Agreement or any application thereof shall be invalid, illegal or unenforceable in any respect, the validity, legality and enforceability of the remaining provisions contained herein and any other application thereof shall not in any way be affected or impaired thereby.

**19. ENTIRE AGREEMENT**

The foregoing constitutes the entire Lease Agreement between the Parties, represents their entire understanding, and defines all of their respective rights, title, and interests as well as all of their duties, responsibilities and obligations. Any and all prior lease agreements and understandings between the Parties related to the Premises, if any, are merged herein. This Lease Agreement shall not be modified or amended except by a written document signed by the Parties.

**20. BINDING EFFECT**

This Lease Agreement shall be binding upon and insure to the benefit of the Parties hereto and their respective successors and permitted assigns.

**21. LITIGATION EXPENSE**

In the event of litigation between the Parties, Lessee shall pay any necessary costs, including reasonable attorney's fees, expenses and other costs of collection or otherwise, which Lessor shall incur in enforcing this Lease Agreement or in recovering any and all damages caused to the Premises by Lessee, or Lessee's contractors, agents, employees or permitted assigns.

**22. HEADINGS**

The section headings contained in this Lease Agreement are for reference purposes only and shall not affect the meaning or interpretation of this Lease Agreement.

### **23. APPLICABLE LAW; VENUE**

In any action, suit or legal dispute arising from this Lease Agreement, Lessee agrees that the laws of the State of New Mexico shall govern. The Parties agree that any action or suit arising from this Lease Agreement shall be commenced in a federal or state court of competent jurisdiction in New Mexico. Any action or suit commenced in the courts of the State of New Mexico shall be brought in the First Judicial District Court.

### **24. AMENDMENT**

This Lease Agreement shall not be altered, changed or modified except by an amendment in writing executed by the Parties hereto.

### **25. SECURITY DEPOSIT**

Lessee shall deposit with City, upon execution hereof, the Security Deposit of one month's rent as security for Lessee's faithful performance of its obligations under this Lease Agreement. If Lessee fails to pay Rent, or otherwise defaults under this Lease Agreement, City may use, apply or retain all or any portion of said Security Deposit for the payment of any amount due City or to reimburse or compensate City for any liability, expense, loss or damage which City may suffer or incur by reason thereof. If City uses or applies all or any portion of the Security Deposit, Lessee shall within 10 days after written request therefor deposit monies with City sufficient to restore said Security Deposit to the full amount required by this Lease Agreement. If the Base Rent increases during the term of this Lease Agreement, Lessee shall, upon written request from the City's Airport Director or Administrative Manager, deposit additional monies with City so that the total amount of the Security Deposit shall always bear the same proportion to the increased Base Rent as the initial Security Deposit bore to the initial Base Rent. Should the Agreed Use be amended to accommodate a material change in the business of Lessee or to accommodate a sublessee or assignee, the City's Airport Director shall have the right to increase the Security Deposit to the extent necessary, in the Airport Director's reasonable judgment, to account for any increased wear and tear that the Premises may suffer as a result thereof. If a change in control of Lessee occurs during this Lease Agreement and following such change the financial condition of Lessee is, in the Airport Director's reasonable judgment, significantly reduced, Lessee shall deposit such additional monies with City as shall be sufficient to cause the Security Deposit to be at a commercially reasonable level based on such change in financial condition. City shall not be required to keep the Security Deposit separate from its general accounts. Within 30 days after the expiration or termination of this Lease Agreement, if City elects to apply the Security Deposit only to unpaid Rent, and otherwise within 60 days after the Premises have been vacated, City shall return that portion of the Security Deposit not used or applied by City. No part of the Security Deposit shall be held in trust, to bear interest or to be prepayment for any monies to be paid by Lessee under this Lease Agreement.

### **26. OBSERVATION OF LAWS, RULES, REGULATIONS, AND FAA GRANT ASSURANCES**

Lessee and Lessor agree to observe and obey during the Term of this Lease, all laws, ordinances, minimum standards, rules and regulations promulgated and enforced by Lessor, and by any other

proper authority having jurisdiction over the conduct of operations at the Airport, including the federal government, the state, the county and the City now or hereafter in effect.

## **27. FAIR AND NONDISCRIMINATORY SERVICES**

Lessee, in the conduct of its authorized business activities, shall furnish good, prompt, and efficient service in compliance with all applicable laws, rules, and regulations adequate to meet the demand for its services at the Airport, and shall furnish such service on a fair, equal, and not unjustly discriminatory basis to all users thereof, and agrees to furnish such services at fair, equal, and not unjustly discriminatory prices for each unit of sale or service; provided, however, that Lessee shall be allowed to make reasonable and nondiscriminatory discounts, rebates, or other similar types of price reductions to volume purchases. Lessee agrees to operate the business in an ethical and professional manner and shall keep the Premises in a safe, clean, orderly, and inviting condition at all times, satisfactory to Lessor's Airport Director. Lessee shall not permit its employees or agents to solicit customers on public property.

## **28. CIVIL RIGHTS ASSURANCES**

- a. Lessee agrees for itself, its employees, and its contractors and subcontractors that:
  - i. No person shall be excluded from participation in, benefits of, or otherwise subjected to discrimination in the use of the Airport on the basis of ethnicity, race, age, religion, creed, color, national origin, ancestry, sex, gender, sexual orientation, physical or mental disability, medical condition, national origin, or citizenship status;
  - ii. In the construction of any improvements on, over, or under the Airport and the furnishing of services thereon, no person shall be excluded from participation in, denied the benefits of, or otherwise subjected to discrimination on the grounds of ethnicity, race, age, religion, creed, color, national origin, ancestry, sex, gender, sexual orientation, physical or mental disability, medical condition, national origin, or citizenship status; and
  - iii. Lessee shall comply with all requirements imposed by or pursuant to Title 49, code of Federal Regulations, Subtitle A, Part 21 in using Airport premises or providing services initiated at the Airport.
  - iv. Lessee assures that it will undertake an affirmative action program as required by 14 C.F.R. Part 152, Subpart E, to ensure that no person shall be excluded from employment activities or any covered service or benefit on a prohibited basis by Lessee, an employee of Lessee, or any contractor or subcontractor.

## **29. ENVIRONMENTAL PROTECTIONS**

- a. Lessee shall not commit or permit commission of any waste on the Airport, or any nuisance or other act or thing that may disturb the quiet enjoyment of the Airport or surrounding property. Lessee shall provide, as necessary, a separate drainage, collection, and/or separation system to

ensure that no untreated liquid waste from any type of operation, including vehicle cleaning, fueling, and oil change operations, will enter the Airport storm drainage or sanitary system.

- b. Lessee shall, at all times, comply with all applicable laws, rules, and regulations of the federal, state, and local government entities. Lessee shall not permit any activity which directly or indirectly produces objectionable or unlawful amounts or levels of air pollution, noise, glare, heat emission, electronic or radio interference with navigational and communications facilities for the operation of the Airport and for Airport use by aircraft, trash, or refuse accumulation, vibration, prop-wash, or jet blast, or which is hazardous or dangerous by reason of risk of explosion, fire, or harmful emission. Any waste oil storage tanks shall be in approved containers and in accordance with all environmental and fire protections regulations.
- c. Hazardous substances are any substance, material, or waste, (including any petroleum products, solvents, thinners, herbicides and soil sterilants, and aircraft deicing fluids) which is or becomes designated, classified, or regulated as being "toxic," "hazardous," a "pollutant," or similar designation under any federal, state, or local law, regulation, or ordinance.
- d. Pursuant to Section 10 (Indemnification) above, Lessee agrees to defend, indemnify, and hold Lessor harmless from and against all liabilities, claims, actions, foreseeable and unforeseeable consequential damages, costs, and expenses (including sums paid in settlement of claims and all consultant, expert, and legal fees and expenses of Lessor's counsel) or loss directly or indirectly arising out of or resulting from the presence of any hazardous substance as a result of Lessee's or any contractor or sub-tenant's activities, whether before, during, or after construction, in or around any part of the property or the soil, groundwater or soil vapor on or under the property, including those incurred in connections with any investigation of site conditions or any cleanup, remedial, removal, or restoration work, or any resulting damages or injuries to the person or property or which is brought against Lessor, whether alone or together with Lessee or any other person.
- e. Lessee shall comply and cause all occupants of the property to comply with all laws, regulations, and ordinances governing or applicable to hazardous substances as well as the recommendations of any qualified environmental engineer or other expert which apply or pertain to the premises. Lessee acknowledges that hazardous substances may permanently and materially impair the value and use of real property. Lessee shall promptly notify Lessor if it knows, suspects, or believes there may be any hazardous substance in or around the property or in the soil, groundwater, or on or under the Airport, or that Lessee or the property may be subject to any threatened or pending investigation by any governmental agency under any law, regulation, or ordinance pertaining to any hazardous substance.

### **30. NONEXCLUSIVE RIGHTS**

- a. Lessee shall have the exclusive right and privilege of engaging in and conducting a business on the Premises of the Airport under the terms and conditions set forth herein, provided, however, that this Agreement shall not be construed in any manner to grant Lessee or those claiming under Lessee in this Agreement the exclusive right to the use of the common areas and facilities of the Airport.
- b. Lessor shall have the right to lease other portions of the Airport or Airport Terminal to lessees, including other ground, air, and transportation services. Lessor shall not in the future form any

other Agreement more favorable or less restrictive to Lessee's than set forth in this Agreement. Lessor understands and agrees that nothing in this Agreement shall be construed as granting or authorizing the granting of an exclusive right within the meaning of Section 308 of the Federal Aviation Act of 1958, as amended.

### **31. SUBORDINATE PROVISIONS**

This Agreement is subject and subordinate to the terms, reservations, restrictions, provisions, and conditions of any existing or future agreement between the Airport and its appurtenant facilities, the execution of which have been or may be required as a condition precedent to the participation by any federal or state agency in the extension, expansion, or development of said airport or its facilities.

*[REMAINDER OF THIS PAGE LEFT BLANK INTENTIONALLY]*

[SIGNATURES APPEAR ON THE FOLLOWING PAGE]

IN WITNESS WHEREOF, the parties have executed this Lease Agreement as of this \_\_\_\_\_ day of \_\_\_\_\_, 20\_\_.

LESSOR: CITY OF SANTA FE

LESSEE: ARINC, INCORPORATED

\_\_\_\_\_  
MICHAEL GARCIA, MAYOR

*Christopher E. Mackey*  
\_\_\_\_\_  
CHRISTOPHER E. MACKEY, VICE PRESIDENT

DATE: \_\_\_\_\_

DATE: 12/4/2025

ATTEST:

\_\_\_\_\_  
GERALYN CARDENAS, INTERIM CITY CLERK

APPROVED AS TO FORM FOR LEGAL SUFFICIENCY:

*Kevin L. Nault*  
Kevin L. Nault (Dec 17, 2025 10:51:04 MST)  
\_\_\_\_\_  
ASSISTANT CITY ATTORNEY

APPROVED AS TO FINANCE:

\_\_\_\_\_  
EMILY K. OSTER, FINANCE DIRECTOR  
Business Unit/Line Item 5456050-460150

[REMAINDER OF THIS PAGE LEFT BLANK INTENTIONALLY]

**Exhibit A – Premises, Terminal Space, IT Closet**

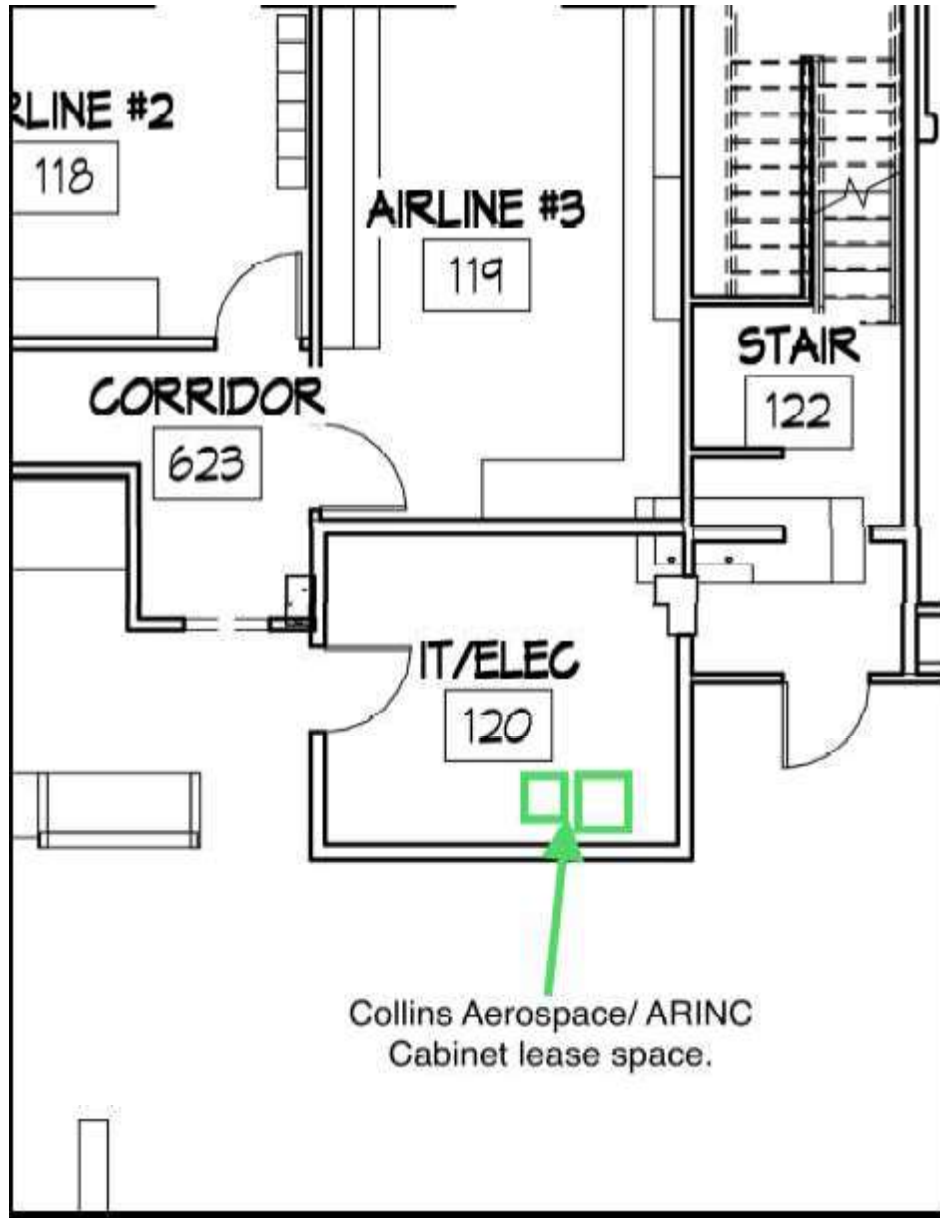

**Exhibit B – Premises, Antenna**



**Exhibit C – Rent Schedule**

Option Years	Year	Term Dates		LSF	Total Annual Rent	Escalation	Monthly Rent	Annual Cost per LSF
	1	9/1/2025	8/31/2026	36.00	\$6,408.00	2.00%	\$534.00	\$178.00
	2	9/1/2026	8/31/2027	36.00	\$6,536.16	2.00%	\$544.68	\$181.56
	3	9/1/2027	8/31/2028	36.00	\$6,666.88	2.00%	\$555.57	\$185.19
	4	9/1/2028	8/31/2029	36.00	\$6,800.22	2.00%	\$566.69	\$188.90
	5	9/1/2029	8/31/2030	36.00	\$6,936.23	2.00%	\$578.02	\$192.67
*	6	9/1/2030	8/31/2031	36.00	\$7,074.95	2.00%	\$589.58	\$196.53
*	7	9/1/2031	8/31/2032	36.00	\$7,216.45	2.00%	\$601.37	\$200.46
*	8	9/1/2032	8/31/2033	36.00	\$7,360.78	2.00%	\$613.40	\$204.47
*	9	9/1/2033	8/31/2034	36.00	\$7,507.99	2.00%	\$625.67	\$208.56
*	10	9/1/2034	8/31/2035	36.00	\$7,658.15	2.00%	\$638.18	\$212.73
*	11	9/1/2035	8/31/2036	36.00	\$7,811.32	2.00%	\$650.94	\$216.98
*	12	9/1/2036	8/31/2037	36.00	\$7,967.54	2.00%	\$663.96	\$221.32
*	13	9/1/2037	8/31/2038	36.00	\$8,126.89	2.00%	\$677.24	\$225.75
*	14	9/1/2038	8/31/2039	36.00	\$8,289.43	2.00%	\$690.79	\$230.26
*	15	9/1/2039	8/31/2040	36.00	\$8,455.22	2.00%	\$704.60	\$234.87
*Option Terms								



# CERTIFICATE OF LIABILITY INSURANCE

DATE (MM/DD/YYYY)

11/14/2025

THIS CERTIFICATE IS ISSUED AS A MATTER OF INFORMATION ONLY AND CONFERS NO RIGHTS UPON THE CERTIFICATE HOLDER. THIS CERTIFICATE DOES NOT AFFIRMATIVELY OR NEGATIVELY AMEND, EXTEND OR ALTER THE COVERAGE AFFORDED BY THE POLICIES BELOW. THIS CERTIFICATE OF INSURANCE DOES NOT CONSTITUTE A CONTRACT BETWEEN THE ISSUING INSURER(S), AUTHORIZED REPRESENTATIVE OR PRODUCER, AND THE CERTIFICATE HOLDER.

**IMPORTANT:** If the certificate holder is an ADDITIONAL INSURED, the policy(ies) must have ADDITIONAL INSURED provisions or be endorsed. If SUBROGATION IS WAIVED, subject to the terms and conditions of the policy, certain policies may require an endorsement. A statement on this certificate does not confer rights to the certificate holder in lieu of such endorsement(s).

<b>PRODUCER</b> MARSH USA, LLC. 20 CHURCH STREET HARTFORD, CT 06103  CN101479273-RTX-ROCK-25-26	<b>CONTACT NAME:</b> _____ <b>PHONE (A/C, No, Ext):</b> _____ <b>FAX (A/C, No):</b> _____ <b>E-MAIL ADDRESS:</b> RTX.CertRequest@marsh.com	
	<b>INSURER(S) AFFORDING COVERAGE</b>	
<b>INSURED</b> ARINC, INCORPORATED 2551 RIVA ROAD ANNAPOLIS, MD 21401	<b>INSURER A :</b> Liberty Mutual Fire Insurance Co <span style="float:right">23035</span>	
	<b>INSURER B :</b> Ohio Casualty Insurance Company <span style="float:right">24074</span>	
	<b>INSURER C :</b> _____	
	<b>INSURER D :</b> _____	
	<b>INSURER E :</b> _____	

**COVERAGES****CERTIFICATE NUMBER:**

NYC-012446500-01

**REVISION NUMBER:**

THIS IS TO CERTIFY THAT THE POLICIES OF INSURANCE LISTED BELOW HAVE BEEN ISSUED TO THE INSURED NAMED ABOVE FOR THE POLICY PERIOD INDICATED. NOTWITHSTANDING ANY REQUIREMENT, TERM OR CONDITION OF ANY CONTRACT OR OTHER DOCUMENT WITH RESPECT TO WHICH THIS CERTIFICATE MAY BE ISSUED OR MAY PERTAIN, THE INSURANCE AFFORDED BY THE POLICIES DESCRIBED HEREIN IS SUBJECT TO ALL THE TERMS, EXCLUSIONS AND CONDITIONS OF SUCH POLICIES. LIMITS SHOWN MAY HAVE BEEN REDUCED BY PAID CLAIMS.

INSR LTR	TYPE OF INSURANCE	ADDL INSD	SUBR WVD	POLICY NUMBER	POLICY EFF (MM/DD/YYYY)	POLICY EXP (MM/DD/YYYY)	LIMITS
A	<input checked="" type="checkbox"/> COMMERCIAL GENERAL LIABILITY <input type="checkbox"/> CLAIMS-MADE <input checked="" type="checkbox"/> OCCUR  GEN'L AGGREGATE LIMIT APPLIES PER: <input checked="" type="checkbox"/> POLICY <input type="checkbox"/> PRO-JECT <input type="checkbox"/> LOC OTHER: _____			TB2-631-510789-015	06/01/2025	06/01/2026	EACH OCCURRENCE \$ 1,000,000 DAMAGE TO RENTED PREMISES (Ea occurrence) \$ 1,000,000 MED EXP (Any one person) \$ 10,000 PERSONAL & ADV INJURY \$ 1,000,000 GENERAL AGGREGATE \$ 10,000,000 PRODUCTS - COMP/OP AGG \$ 2,000,000 \$ _____
	<b>AUTOMOBILE LIABILITY</b> <input type="checkbox"/> ANY AUTO <input type="checkbox"/> OWNED AUTOS ONLY <input type="checkbox"/> SCHEDULED AUTOS <input type="checkbox"/> HIRED AUTOS ONLY <input type="checkbox"/> NON-OWNED AUTOS ONLY						COMBINED SINGLE LIMIT (Ea accident) \$ _____ BODILY INJURY (Per person) \$ _____ BODILY INJURY (Per accident) \$ _____ PROPERTY DAMAGE (Per accident) \$ _____ \$ _____
B	<input checked="" type="checkbox"/> UMBRELLA LIAB <input checked="" type="checkbox"/> OCCUR <input type="checkbox"/> EXCESS LIAB <input type="checkbox"/> CLAIMS-MADE DED _____ RETENTION \$ _____			EUO (26) 63290185	06/01/2025	06/01/2026	EACH OCCURRENCE \$ 10,000,000 AGGREGATE \$ 10,000,000 \$ _____
	<b>WORKERS COMPENSATION AND EMPLOYERS' LIABILITY</b> ANY PROPRIETOR/PARTNER/EXECUTIVE OFFICER/MEMBER EXCLUDED? <input type="checkbox"/> Y <input checked="" type="checkbox"/> N (Mandatory in NH) If yes, describe under DESCRIPTION OF OPERATIONS below		N/A				<input type="checkbox"/> PER STATUTE <input type="checkbox"/> OTHER E.L. EACH ACCIDENT \$ _____ E.L. DISEASE - EA EMPLOYEE \$ _____ E.L. DISEASE - POLICY LIMIT \$ _____

**DESCRIPTION OF OPERATIONS / LOCATIONS / VEHICLES (ACORD 101, Additional Remarks Schedule, may be attached if more space is required)**

RE: MEMORANDUM OF AGREEMENT BETWEEN ARINC AND SANTA FE MUNICIPAL AIRPORT  
 LEASED SPACE: SIX (6) SQUARE FEET OF SPACE IN THE TERMINAL IT/DATA ROOM  
 CITY OF SANTA FE AND THE SANTA FE MUNICIPAL AIRPORT IS/ARE INCLUDED AS ADDITIONAL INSURED WHEN REQUIRED BY WRITTEN CONTRACT AND/OR AGREEMENT.

**CERTIFICATE HOLDER****CANCELLATION**

Santa Fe Municipal Airport Attn Airport Manager 121 Aviation Drive Santa Fe, NM 85705	SHOULD ANY OF THE ABOVE DESCRIBED POLICIES BE CANCELLED BEFORE THE EXPIRATION DATE THEREOF, NOTICE WILL BE DELIVERED IN ACCORDANCE WITH THE POLICY PROVISIONS.  AUTHORIZED REPRESENTATIVE  <i>Marsh USA LLC</i>
--	---

© 1988-2016 ACORD CORPORATION. All rights reserved.

Policy Number TB2-631-510789-015  
Issued by Liberty Mutual Fire Insurance Co.

**THIS ENDORSEMENT CHANGES THE POLICY. PLEASE READ IT CAREFULLY.**

**NOTICE OF CANCELLATION TO THIRD PARTIES**

This endorsement modifies insurance provided under the following:

BUSINESS AUTO COVERAGE PART  
MOTOR CARRIER COVERAGE PART  
GARAGE COVERAGE PART  
TRUCKERS COVERAGE PART  
EXCESS AUTOMOBILE LIABILITY INDEMNITY COVERAGE PART  
SELF-INSURED TRUCKER EXCESS LIABILITY COVERAGE PART  
COMMERCIAL GENERAL LIABILITY COVERAGE PART  
EXCESS COMMERCIAL GENERAL LIABILITY COVERAGE PART  
PRODUCTS/COMPLETED OPERATIONS LIABILITY COVERAGE PART  
LIQUOR LIABILITY COVERAGE PART

- A. If we cancel this policy for any reason other than nonpayment of premium, we will notify the persons or organizations shown in the Schedule of this endorsement. We will send notice to the email or mailing address listed above at least 10 days, or the number of days listed above, if any, before the cancellation becomes effective. In no event does the notice to the third party exceed the notice to the first named insured.
- B. This advance notification of a pending cancellation of coverage is intended as a courtesy only. Our failure to provide such advance notification will not extend the policy cancellation date nor negate cancellation of the policy.

All other terms and conditions of this policy remain unchanged.

**Schedule**

<b>Name of Other Person(s) / Organization(s):</b>	<b>Email Address or mailing address:</b>	<b>Number Days Notice:</b>
Per schedule on file with the agent of record or the Company	Per schedule on file with the agent of record or the Company	30



# City of Santa Fe, New Mexico

200 Lincoln Avenue, P.O. Box 909, Santa Fe, N.M. 87504-0909

[www.santafenm.gov](http://www.santafenm.gov)

*Alan Webber, Mayor*

Councilors:

Signe I. Lindell, Mayor Pro Tem, District 1

Alma G. Castro, District 1

Michael J. Garcia, District 2

Carol Romero-Wirth, District 2

Lee Garcia, District 3

Pilar F.H. Faulkner, District 3

Jamie Cassutt, District 4

Amanda Chavez, District 4

Dear City Staff,

In accordance with State Statute and City Ordinances, this document serves as a blanket services' determination and is valid until June 30, 2026, for the types of general, professional, and construction services that are clearly one of the types pre-established and approved by the State Purchasing Agent and City CPO.

Please continue to obtain determinations for services that do not clearly and fully fit within the types listed below. For mixed or hybrid services, unclear scopes of work, and design-build projects, specific determinations will be required. In these cases, please email [purchasing\\_det@santafenm.gov](mailto:purchasing_det@santafenm.gov) to obtain the necessary CPO determinations for your procurement needs.

Should you have any questions or require clarification on a particular service, feel free to contact CPD.

## **The following are General Services:**

- Air/bus, vehicle charter/rental service
- Animal/k9 boarding - basic
- Auctioneers
- Audio-visual equipment setup and routine maintenance for events and presentations (including projectors, microphones, and speakers)
- Automotive mechanical services – all - including vehicle inspection, diagnostics, repair labor, parts replacement, and routine maintenance (e.g., oil changes, brake service, tune-ups, etc.)
- Banking Services (routine, transaction-based)
- Boiler testing/water treatment service
- Bookkeeping service (routine, transaction-based)
- Biohazard clean-up and disinfection services for crime scenes, homicides, suicides, unattended deaths, car accidents, deadly car crashes and cleanup of police units, along with any other biohazard situations. Building alarm systems, service and repair
- Check collection service
- Clothing, textile fabrication repair service

**General Services (continued):**

- Commercial laundry service, dry cleaning, etc.
- Communications systems installation, servicing, and repair
- Conference and trade show coordination
- Debt collection service
- Delivery/courier service
- Document storage, duplication, retrieval, review, and destruction service
- Drug testing and screening (standard tests)
- Engraving service
- Equipment installation, preventive maintenance, inspection, calibration, and repair
- Equipment rental services
- Exams administration and scoring service
- Executive recruitment
- Firefighting/suppression service
- Food preparation, vending, and catering services
- Health screening, basic diagnostic (wellness, blood pressure monitoring, blood draw, etc.)
- Herbicide application service
- Household goods packing, storage, transportation service
- HVAC system maintenance service - Includes filter changes, inspections, cleaning, minor repairs, and system diagnostics.
- Information Technology - Hosting only
- Information Technology Help Desk Services
- Information Technology Services requiring software or equipment
- Information Technology Software and Hardware Support Services
- Interpretive services: written/oral/sign language
- Inventory service
- Janitorial service, carpet cleaning, window washing
- Laboratory testing and analysis (standard tests only)
- Land clearing/debris removal service
- Landscaping—tree planting, grooming service, lawn mowing, etc. (but not landscape architects)
- Language translation service
- Linen rental service

**General Services (continued):**

- Marine equipment inspection, certification, and repair
- Medical equipment rental or repair service (wheelchairs, walkers, etc.), including measurements, adjustments, and modifications to meet patient needs
- Metal/pipe/wiring detection service
- Office furnishings installation, refurbishment, and repair service
- Package inspection and crating
- Painting service
- Paper shredding
- Parking lot sweeping/snow removal service
- Pest/weed control service
- Photographic/micrographic processing and delivery, includes aerial and ground photography (if analysis is included, then personal service)
- Printing/duplicating service
- Process serving
- **Property management (rent collection, property maintenance, etc.)**
- Recycling/disposal/litter pickup service
- Retreat and workshop planning, conduct, coordination, etc.
- Security/armored car services
- Shop welding/metal fabrication service
- Software as a Service
- Steam cleaning, high pressure washing, parts cleaning service
- Studio photography service (does not include portrait painting)
- Telephone interview service (conduct of survey using prescribed survey instrument)
- Towing service
- Traffic control services – including certified flaggers, barricade setup/removal, temporary signage, and traffic control plans (not involving permanent installations or design engineering)
- Training – when offered as a regular course by an institution (such as a college or university)
- Travel service — air, surface, water
- Videotaping and recording service
- Warehouse dry/cold storage rental service
- Weather information service

**The following are Professional Services:**

- Accountants (certified public accountants and registered public accountants)
- Actuaries
- Analysts of processes, programs, fiscal impact, and compliance
- Appraisers
- Archeologists
- Architects
- Artwork, original (services creating the artwork)
- Audio/video media productions (design, development, and/or oversight of)
- Auditors
- Broadband
- Business process re-engineering
- Counselors
- Consultants (including IT Consultants)
- Curriculum/Examination development
- Data Backup Services
- Data Storage and Management Services
- Design
- Economists
- Engineers
- Environmental monitoring: noise level, safety, hazardous gas detection, radiation monitoring service, etc.
- Financial Advisors
- Grant writing
- Graphic designers (creative or original in nature)
- Hearing officer services
- Independent Verification and Validation
- Information Technology Hosting when it includes Maintenance and Support
- Information Technology Maintenance
- Information Technology Management
- Information Technology Programming
- Information Technology Risk Assessment

**Professional Services (Continued):**

- Insurance Adjusters/Brokers
- Investigators (personnel-related, etc.)
- Investment advisors and management
- Labor negotiators
- Landscape Architects
- Lawyers
- Lobbyists
- Managed Network Services
- Management and system analysts
- Management consultants
- Marketing consultants (including identifying market opportunities, conduct of marketing programs, planning, promotion, market research surveys, etc.)
- Medical arts practitioners
- Medical – doctors, immunizations, etc.
- Mental health support – Therapists, Counselors, etc.
- Network Cybersecurity Services
- Network Installation
- Physicals
- Planners
- Policy Advisors
- Polygraph services
- Product Development Services
- Program/Project Managers
- Psychologists
- Public relations advisors/Publicists
- Publication development (creation of audio/video productions, brochures, pamphlets, maps, signs, posters, annual reports, etc.)
- Researchers
- Scientists (Bio/Chem/Env/Geo/Hydro/Mech, etc.)
- Social and Human Services - Includes case management, outreach, crisis intervention, supportive housing assistance, and other services intended to support vulnerable or at-risk populations. Services may be delivered by licensed or trained professionals in coordination with public or nonprofit systems.

**Professional Services (Continued):**

- Speech writers
- Statisticians
- Surveyors
- Trade developers
- Training – when it is specifically designed for an agency as opposed to established courses (such as out of the box training offered to all at a training company, university, or college)
- Veterinarian services
- Web design and development

**The following are Construction Services:**

- Bid-Build (Standard)
- Construction Managers
- New Construction (including buildings, roads, bridges, utilities)
- Remodeling and Renovations (interior and exterior work)
- Demolition (including site clearance)
- Excavation and Earthwork
- Electrical Work (installation, repair, upgrades)
- Permanent installation or upgrades of audio-visual systems (including wiring and structural modifications)
- Plumbing (installation, repair, maintenance)
- Masonry and Concrete Work
- Roofing (installation, repair, maintenance)
- Structural Repair and Reinforcement
- Stucco installation, repair, and finishing
- Painting and Finishing (for construction purposes)
- Mechanical Work (HVAC systems, etc.)
- Site Preparation and Land Grading
- Utility Installation and Repair (water, sewer, gas lines)

Travis Dutton-Leyda, Chief Procurement Officer



Date: 06/30/2025

Emily Oster, Finance Director

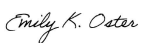

Date: 06/30/2025

**Signature:** 

**Email:** tjlease@santafenm.gov

**Signature:** 

**Email:** jdgunn@santafenm.gov

**Signature:** *BRIAN MOYA*

**Email:** bjmoya@santafenm.gov