

# Santa Fe Median Beautification - Project Update

**Santa Fe City Council – August 27, 2025**

# Introductions

**Client:** City of Santa Fe Parks and Open Space

Melissa McDonald – Parks and Open Space Division Director

Scott Overlie– Parks and Open Space Division Project Manager III

**Design:** Sites Southwest

George Radnovich– Principal Landscape Architect

Shasta Meehan– Senior Landscape Designer

**Engineering:** Souder Miller & Associates

Raymond Smith– Senior Manager/Central NM General Civil Tech Sector Director





# Summary of Project Work

**Project Abstract:** Develop landscape designs for four gateway medians in Santa Fe that are beautiful, safe, and sustainable while highlighting the city's history and culture. The project will also provide adaptable design templates and an implementation plan for citywide median improvements.

## **Total Project Funding:**

- **1.7M Legislative and One Time GRT Appropriations Currently Funded**
- **3.8M Additional Funding Estimated (cost increases are possible)**

## **Project Development:**

- **Public Engagement**
  - 5 meetings completed, 1 meeting remaining
- **Design and Construction Plans**
  - Airport Rd Gateway
  - Cerrillos Rd Gateway
  - N St. Francis Dr. Gateway
  - Old Pecos Trail Gateway
- **Construction Start Expected Spring of 2026**



# Project Goals

- **Safety** - Prioritize roadway safety and provide traffic calming features
- **Sustainability** – Reduce water use and maintenance needy landscapes
- **Sense of Place** – Beautify entrance medians to create a sense of arrival
- **Guidelines** - Develop median design guidelines for efficiency

# Site Context – Gateway Median Reaches

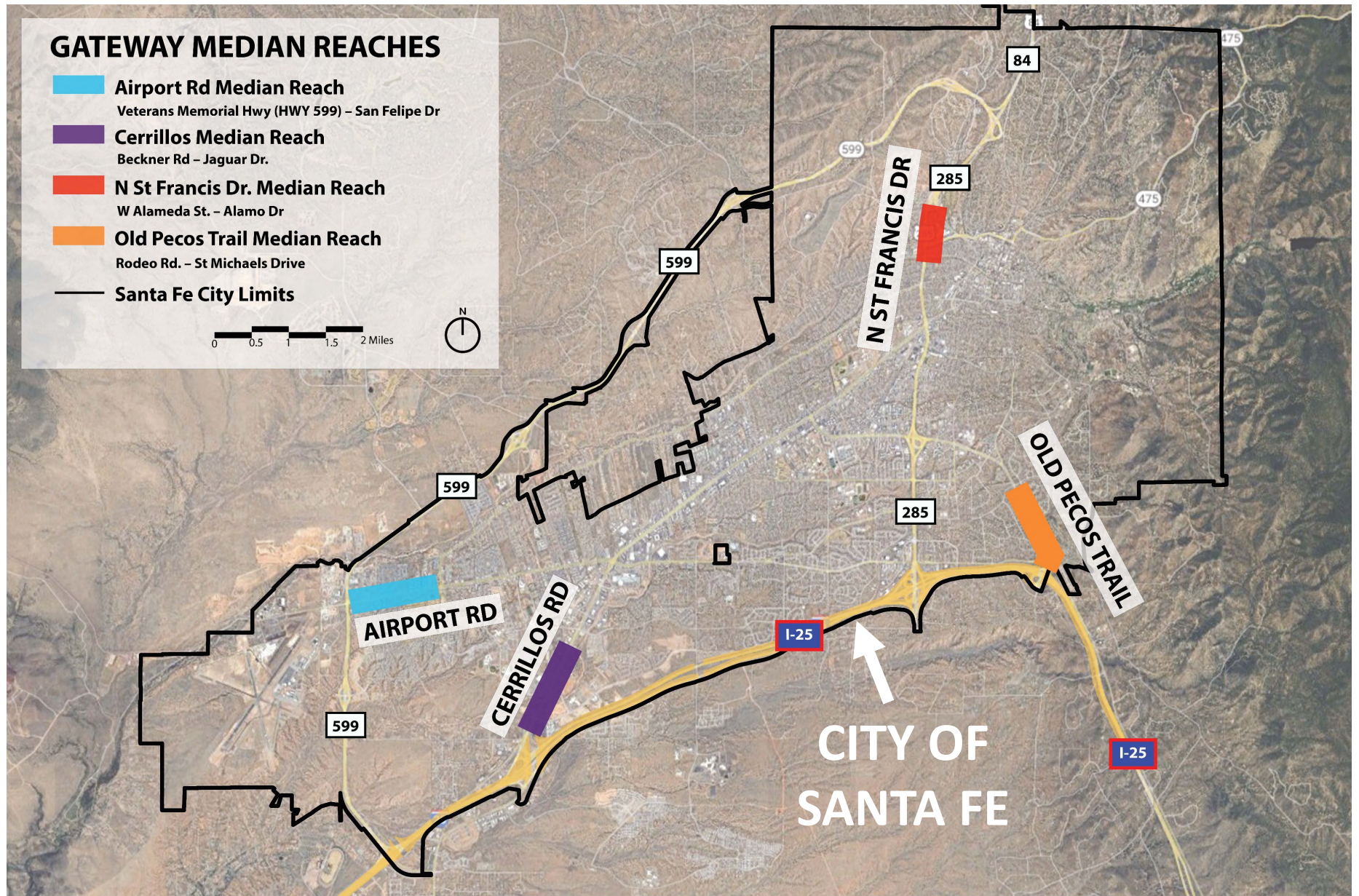



# Community and Stakeholder Outreach

## Neighborhood and Community Meetings:

A total of **5 public meetings** have been held to engage the public with both conceptual and schematic designs for the 4 gateway median reaches.

## 2024-2025 Stakeholder Interviews:

Conducted from December 2024 – Current

## Organizations:

Held interviews with representatives from:

- City of Santa Fe Public Works Department
- City of Santa Fe Complete Streets
- City of Santa Fe Parks and Streets Maintenance Crew
- City of Santa Fe Arts and Culture Department
- Santa Fe MPO
- Santa Fe Rotary Club
- Keep Santa Fe Beautiful

# Current Gateway Median Challenges

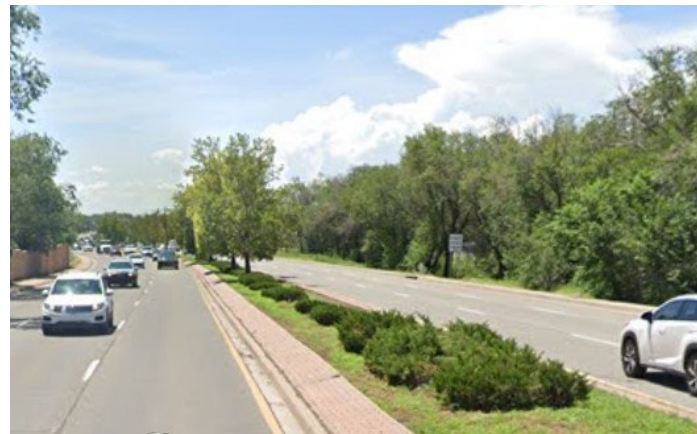

## KEY CHALLENGES:

- High Maintenance
- High Water Use
- Needs Irrigation Repair (broken)
- No Sense of Arrival to City
- No Consistency
- No Representation of City Character
- Lack of Safety

# Proposed Gateway Median Design – Airport Rd



# Proposed Gateway Median Design – Airport Rd

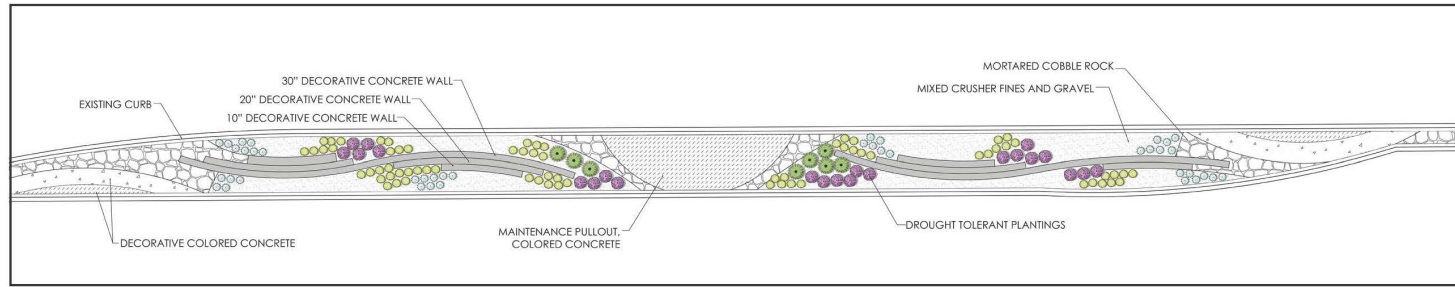

TYPICAL MEDIAN DESIGN

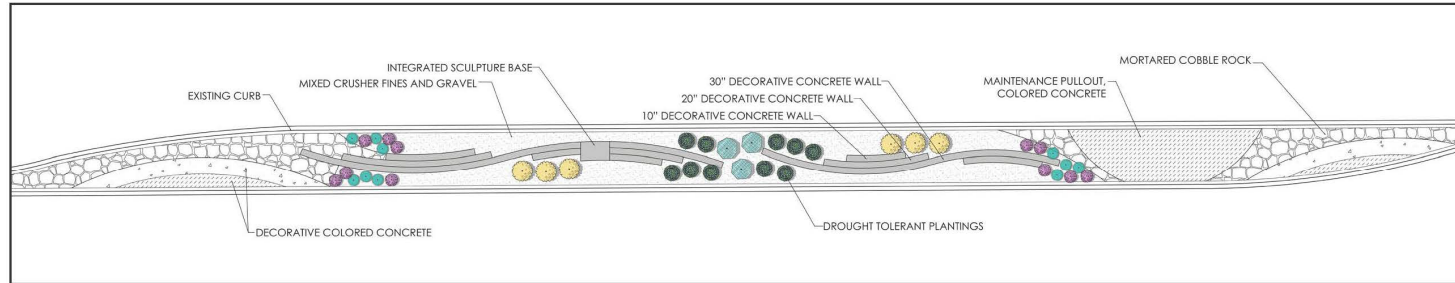

MEDIAN DESIGN AT POTENTIAL ARTWORK LOCATIONS



BEAR GRASS

NEW MEXICO AGAVE



RED YUCCA

BLUE MIST SPIREA



DWARF CHAMISA

SOAPWEED YUCCA



BLUE MORMON TEA

AUTUMN AMBER SUMAC

## PLANT MATERIALS



MORTARED COBBLE



DECORATIVE COLORED CONCRETE



MIXED CRUSHER FINES AND GRAVEL

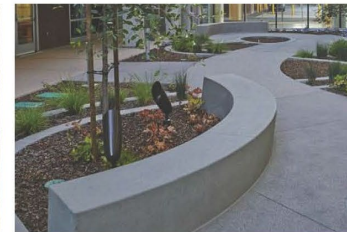

CURVILINEAR CONCRETE WALLS

## HARDSCAPE MATERIALS

# Proposed Gateway Median Design – Cerrillos Rd



# Proposed Gateway Median Design – Cerrillos Rd

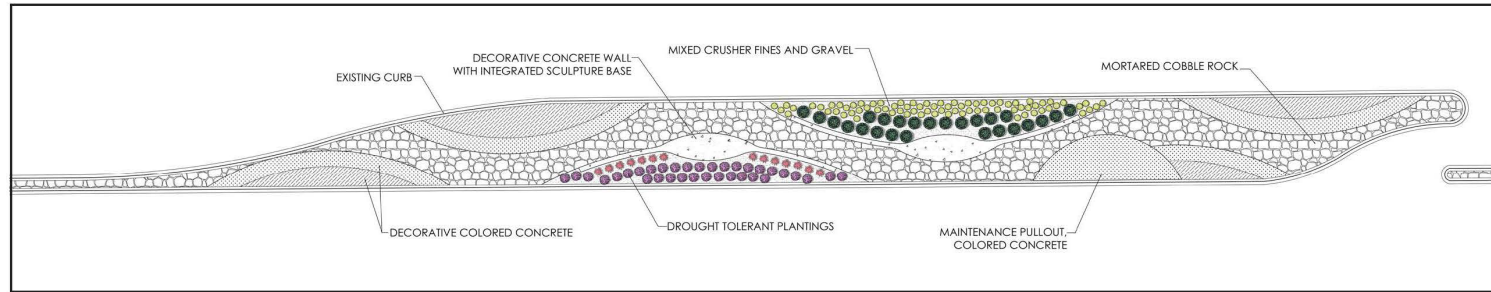

TYPICAL MEDIAN DESIGN

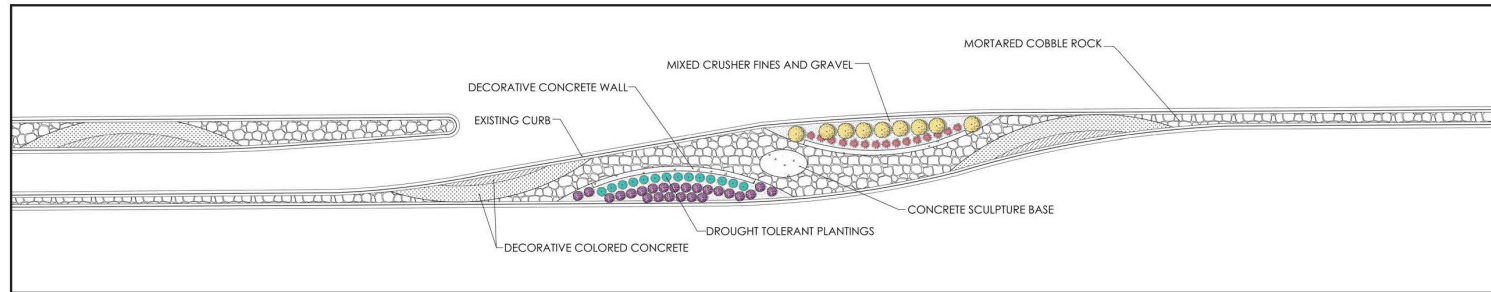

A-TYPICAL MEDIAN DESIGN



BEAR GRASS

NEW MEXICO AGAVE



RED YUCCA

BLUE MIST SPIREA



DWARF CHAMISA

SOAPWEED YUCCA



BLUE MORMON TEA

AUTUMN AMBER SUMAC

## PLANT MATERIALS



MORTARED COBBLE



DECORATIVE COLORED CONCRETE

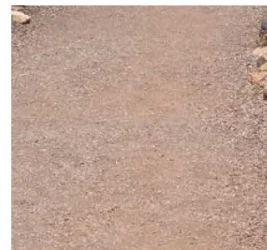

MIXED CRUSHER FINES AND GRAVEL



CURVILINEAR CONCRETE WALLS



GLASSWORK IN CONCRETE WALLS

## HARDSCAPE MATERIALS

# Proposed Gateway Median Design – St Francis Dr



# Proposed Gateway Median Design – St Francis Dr

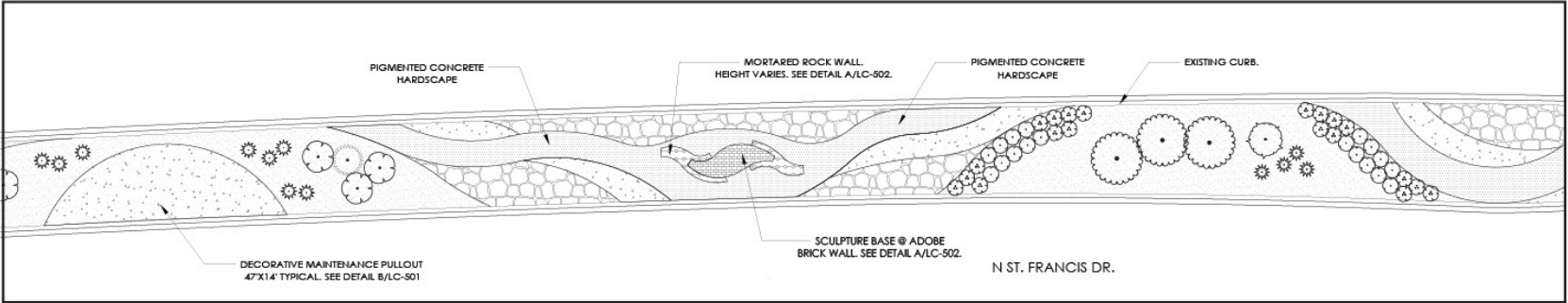

## TYPICAL MEDIAN DESIGN



MORTARED COBBLE



DECORATIVE COLORED CONCRETE



MIXED CRUSHER FINES AND GRAVEL



MOSS ROCK WALL



STUCCO WALL

## HARDSCAPE MATERIALS



RED YUCCA



BLUE MIST SPIREA



FERNBUSH



CINQUEFOIL



DWARF CHAMISA



NEW MEXICO PRIVET



WESTERN SAND CHERRY



YARROW



NEW MEXICO AGAVE



BEAR GRASS



BLUE MORMON TEA



DESERT SAGE



THREE LEAF SUMAC

## PLANTING MATERIALS

# Proposed Gateway Median Design – Old Pecos Trail

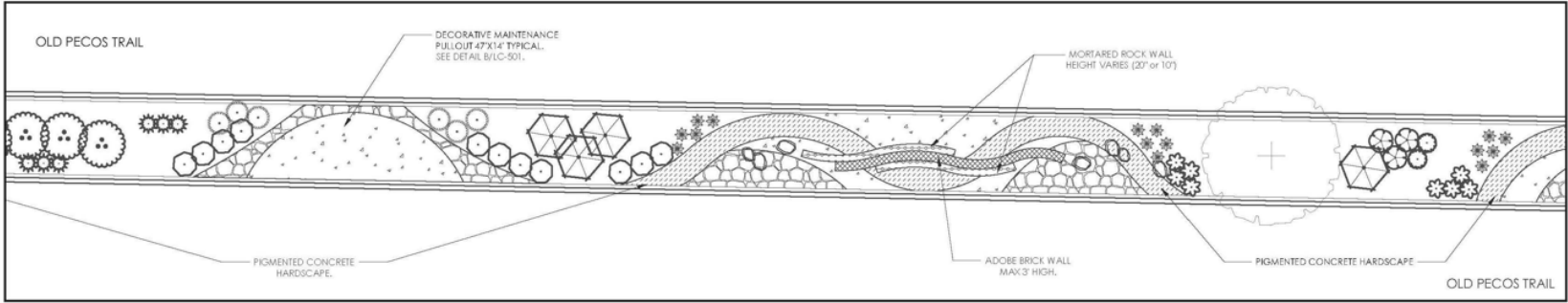

## TYPICAL MEDIAN DESIGN



MORTARED COBBLE



DECORATIVE COLORED CONCRETE



MIXED CRUSHER FINES AND GRAVEL



DECORATIVE BOULDERS



MORTARED ROCK WALL



ADOBE BRICK WALL



STUCCO WALL

## HARDSCAPE MATERIALS



RED YUCCA



BLUE MIST SPIREA



FERNBUSH



CINQUEFOIL

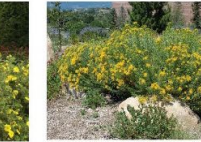

DWARF CHAMISA



APACHE PLUME



MOUNTAIN MAHOGANY



WESTERN SAND CHERRY



YARROW



NEW MEXICO AGAVE



BEAR GRASS



BLUE MORMON TEA



DESERT SAGE



THREE LEAF SUMAC

## PLANTING MATERIALS



# NEXT STEPS:

## **1. Public Engagement and Stakeholder Outreach**

- 80% completed, 1 more additional Public Meeting planned for Final Outreach

## **2. Final Design and Construction documents**

- 100% Construction Drawings for all 4 Gateway Median Reaches
- Construction expected to begin Spring of 2026 on Airport Rd. Gateway

## **3. Design Guideline Template for Future Median Designs**